



## About Us

S J Smith Estate Agents was founded with a singular goal – to provide an unparalleled level of service and client care not readily available in our local market.

Our aim is to establish S J Smith as the premier estate agency in our area of operations. To that end, we blend proven real estate practices with cutting-edge technology to deliver the very best service possible.

However, our greatest asset is our exceptional staff, whose dedication and expertise set us apart from competitors.

Let's stay in touch!  
Get tips, sneak peeks, and early access to our newest properties!



[www.sjsmithestateagents.co.uk](http://www.sjsmithestateagents.co.uk)

## Client Testimonials

“ We recently bought a property through SJ Smith in Ashford and had a great experience from start to finish. Robert and Simon were both excellent – always polite, helpful, and quick to respond to any enquiries. Communication was clear and consistent throughout, and we really appreciated that there was no pressure or pushy sales tactics, unlike with some other agents we dealt with. We felt genuinely supported during the process and would highly recommend their service based on our experience. ”

*Tomasz Nowak*

“ Amazing, Outstanding customer service! We have sold and purchased 3 properties now with SJ past 12 years! This experience was however the best one to date! Would recommend this company to all wanting to sell or let there properties in the Ashford, Surrey or surrounding areas. Well done all involved! Top Work!!! ”

*Mark Sheldrake*

“ Absolutely brilliant service from all the staff working in SJ Smith Ashford that supported us during our house process. Couldn't fault anyone, they were a productive, helpful and friendly estate agents. We have been greatly appreciative of all the updates during the process and the constant reassurance they've provided us with along the journey. ”

*Dani Atkinson*

“ We sold our house with SJ Smiths and they were incredible throughout. Their photographer did a fantastic job at capturing our home from some tricky angles. Then when our house went on sale, they were very responsive and communicative throughout the viewings process, giving us feedback after each viewing. Our house sold within a week and we really do believe that was down to their hard work. We are so glad we chose S J Smiths and couldn't recommend them more. Thanks so much guys. ”

*Holly*

“ Most honest and experienced estate agents in the area. Easy to work with. We had a tight deadline to meet in order to beat the stamp duty increase. I would definitely recommend going with them whether you have to sell or purchase. They work towards making things happen for you. ”

*Alekhya Jarathi*



6 Station Approach  
Ashford  
Middlesex  
TW15 2QN

t: 01784 243333  
e: [ashford@sjsmithestateagents.co.uk](mailto:ashford@sjsmithestateagents.co.uk)  
[www.sjsmithestateagents.co.uk](http://www.sjsmithestateagents.co.uk)



**16 Edward Way, Ashford, TW15 3AY**

**£565,000 - Freehold**

A three-bedroom semi-detached family home, offering a rare opportunity on this road as one of the few properties yet to be extended to its full potential. The property presents excellent scope to significantly increase the footprint and, subject to the usual permissions, almost double the existing accommodation. To the front, a driveway provides off-street parking and leads to a garage, complemented by a charming front garden. A bright and airy entrance hallway opens into the bay-fronted reception room, featuring a central fireplace with a wood-burning stove, creating a cosy and inviting living space. Spanning the rear of the ground floor is the kitchen/dining room. The kitchen is fitted with a range of units and granite worktops, along with a butler sink, integrated wine fridge, and space for a range cooker and freestanding fridge freezer. This generous room comfortably accommodates a dining table, with a PVC patio door providing access to the garden. Upstairs, the first floor comprises two well-proportioned double bedrooms, both benefiting from a mix of fitted and freestanding furnishings, along with a good-sized third bedroom. The family bathroom is particularly impressive, featuring a four-piece suite including a freestanding bath, walk-in shower, and a sunken TV unit for added luxury. Externally, the rear garden wraps around the property and is mainly laid to lawn, bordered by a variety of shrubs and small fruit trees. Beyond the boundary lies green belt land, often home to grazing horses, ensuring a high degree of privacy and the reassurance of protected, non-developable outlook.

- SEMI DETACHED FAMILY HOME
- THREE BEDROOMS
- OFF STREET PARKING
- GARAGE
- GREAT POTENTIAL FOR EXTENSION (STPP)
- WOOD BURNING STOVE
- EPC RATING BAND D

Approximate Gross Internal Area = 84.72 sq m / 912 sq ft  
 Garage & Stores = 20.57 sq m / 221 sq ft  
 Total = 105.29 sq m / 1133 sq ft

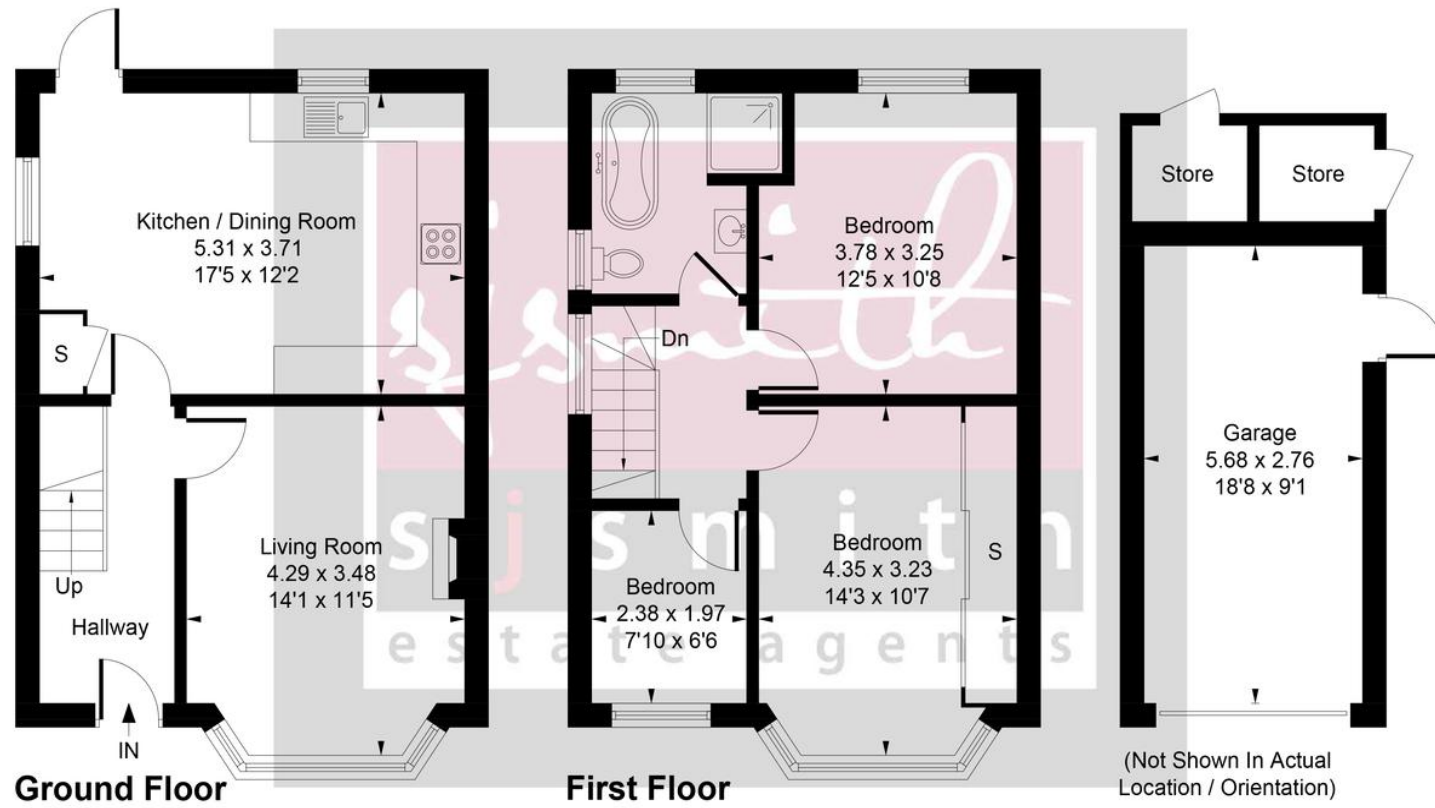

Whilst every attempt has been made to ensure the accuracy of the floor plan contained here, measurements of doors, windows, rooms and any other items are approximate and no responsibility is taken for any error, omission, or mis-statement. This plan is for illustrative purposes only and should be used as such by any prospective purchase.



### Council Tax

Spelthorne Borough Council, Tax Band E being £3,087.93 for 2025/26 Council tax bands can be reassessed by local authorities at any point, the council tax band is only taken at point of listing and should not be relied on as current banding

Tenure: Freehold

**Agent note** Under Consumer Protection Regulations we have endeavoured to make these details as reliable and as accurate as possible. The accuracy is not guaranteed and does not form part of any contract as the details are prepared as a general guide. We have not carried out a detailed survey or tested any appliances, specific fittings, or services (gas/electric). Room sizes should not be relied upon for carpets or furnishing nor should internal photos as these are intended as a guide only and may have changed since. It should not be assumed that any furniture/fittings are included. Lease, ground rent, maintenance or any other charges have been provided by the vendor and their accuracy cannot be guaranteed. We always advise a buyer should obtain verification on points via a solicitor.