



Applegate
Properties



- Ground floor flat
- One double bedroom
- Central village location
- Contemporary interior

North Road, Huddersfield, West Yorkshire, HD8 0RR

£525 pcm

*** MINIMUM 12 MONTHS RENTAL AGREEMENT ***

A well presented and modern one bedroom ground floor flat with small courtyard garden ideally located in centre of popular Kirkburton village.



PROPERTY DESCRIPTION

*** MINIMUM 12 MONTHS RENTAL AGREEMENT

Occupying a central position close to popular village amenities is this well presented ground floor flat. Having electric heating, stylish fittings and briefly comprising: shared entrance with private door to open plan Living / Kitchen having fitted wood effect flooring, fitted kitchen area with modern units and appliances, double bedroom with hanging space, French doors and an en suite bathroom furnished with a three piece white suite.

Externally, there is a small courtyard garden accessed via the bedroom.

EPC: D
Council Tax Band: A

Rent - £525 pcm
Bond - £610
Holding Deposit £122

Please note before your referencing can be approved a holding fee equivalent to one week's worth of the monthly rent must be paid.

- (1) Right to Rent legislation - we will require certain identification documentation from prospective tenants during the referencing process which may require your co-operation
- (2) The property particulars do not constitute part or all of an offer or contract
- (3) The text, photographs and floor plans are for guidance only and should not be relied upon. Dimensions should be verified by yourself if require these to be accurate
- (4) You should make your own enquiries regarding the property, particularly in respect of furnishings to be included/excluded, and other items that may affect you
- (5) The condition and contents of the property will normally be set out in a tenancy agreement and inventory. Please make sure you carefully read and agree with any relevant documents before signing these



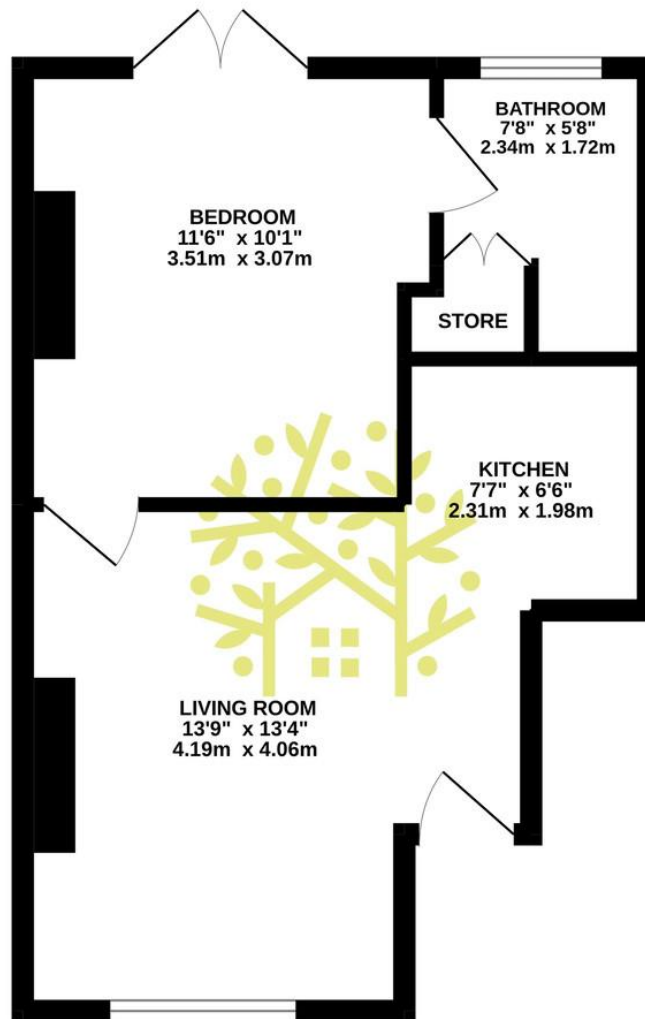

Whilst every attempt has been made to ensure the accuracy of the floorplan contained here, measurements of doors, windows, rooms and any other items are approximate and no responsibility is taken for any error, omission or mis-statement. This plan is for illustrative purposes only and should be used as such by any prospective purchaser. The services, systems and appliances shown have not been tested and no guarantee as to their operability or efficiency can be given.
Made with Metropix ©2022

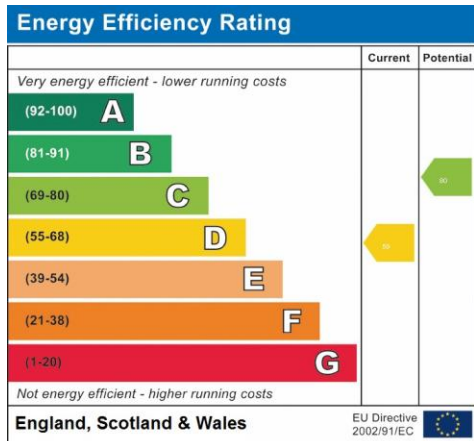

Address:
North Road, Huddersfield

Tenure & Boundaries

The tenure and boundary ownership have not been checked on the title deeds for discrepancies or rights of way if any by the agent.

Floor Plan

All plans are for illustrative purposes only and are not to scale. Due to variations and tolerances in metric and imperial measurements, the measurements contained in these particulars must not be relied upon. Those wishing to order carpets, curtains, furniture or other equipment must arrange to obtain their own measurements.

Copyright: Drawing by Applegate Properties

Measurements

Due to variations and tolerances in metric and imperial measurements, the measurements contained in these particulars must not be relied upon. Those wishing to order carpets, curtains, furniture or other equipment must arrange to obtain their own measurements.

Services, Fittings & Equipment

At the time we received instruction to place the property on the market, services, fittings and equipment referred to in the sales details had not been tested or checked. No warranty can be given as to their condition. No mains services have been checked.

Any intending purchaser must satisfy themselves to the condition of the property and any fittings, as no warranty is provided by the seller, agent or representatives employed by them.

Copyright

Unauthorised reproduction prohibited

Office Opening Hours

Monday – Friday 9.00am – 5.00pm

Saturday – 9.00am – 4.00pm

Sunday - CLOSED

78 Huddersfield Road, Holmfirth, HD9 3AZ

www.applegateproperties.co.uk
01484 682999
info@applegateproperties.co.uk