

TO LET



Zion Terrace, Norden, OL12 7RE
£650 pcm

MARTIN & CO

Zion Terrace, Norden, OL12 7RE

Date available: 15th February 2021

Deposit: £750

Unfurnished

Council Tax band: A

- Two Bedroom Character Cottage
- Holding Deposit- £150
- Security Deposit- £750
- FULLY REFURBISHED
- Quiet Location in the Heart of the Village
- Modern Family Bathroom
- Modern Fitted Kitchen

Score	Energy rating	Current	Potential
92+	A		94 A
81-91	B		
69-80	C	76 C	
55-68	D		
39-54	E		
21-38	F		

CHARACTER COTTAGE - FULLY REFURBISHED - MODERN KITCHEN & BATHROOM - IN THE HEART OF NORDEN VILLAGE - LONG TERM TENANT PREFERRED

GROUND FLOOR
314 sq.ft. (29.1 sq.m.) approx.

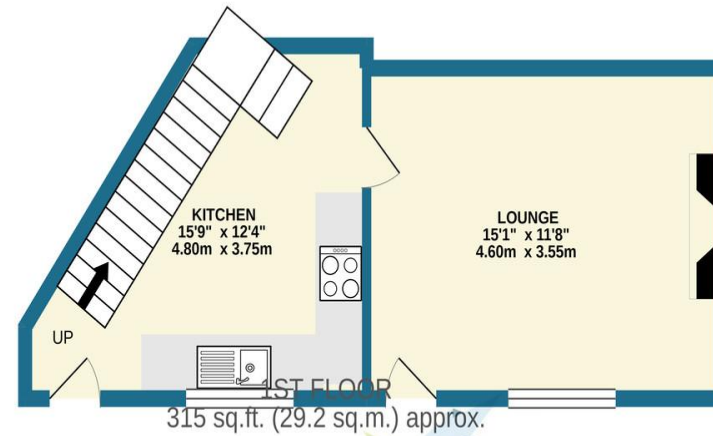

315 sq.ft. (29.2 sq.m.) approx.

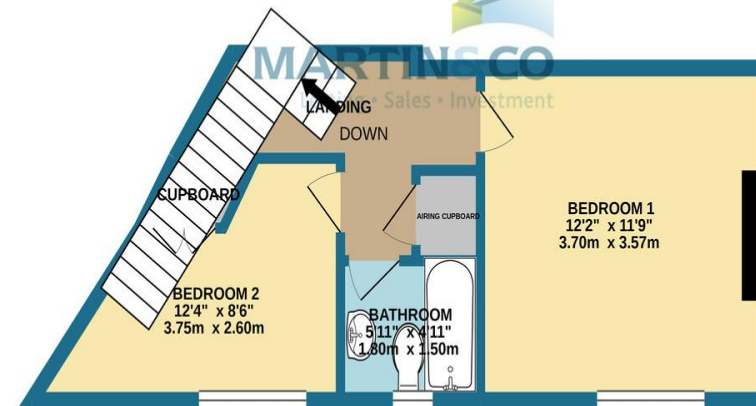

Martin & Co Rochdale

15b Cheetham Street • Rochdale • OL16 1DG
T: 01706 648277 • E: rochdale@martinco.com

01706 648277
rochdale.martinco.com

MARTIN&CO

Accuracy: References to the Tenure of a Property are based on information supplied by the Seller. The Agent has not had sight of the title documents. A Buyer is advised to obtain verification from their Solicitor. Items shown in photographs including but not limited to carpets, fixtures and fittings are not included unless specifically mentioned within the sales particulars. They may however be available by separate negotiation. Buyers must check the availability of any property and make an appointment to view before embarking on any journey to see a property. No person in the employment of the agent has any authority to make any representation about the property, and accordingly any information given is entirely without responsibility on the part of the agents, sellers(s) or lessors(s). Any property particulars are not an offer or contract, nor form part of one. **Sonic / Laser Tape:** Measurements taken using a sonic / laser tape measure may be subject to a small margin of error. **All Measurements:** All Measurements are Approximate. **Services Not tested:** The Agent has not tested any apparatus, equipment, fixtures and fittings or services and so cannot verify that they are in working order or fit for the purpose. A Buyer is advised to obtain verification from their Solicitor or Surveyor.