



Finians Field, Barns Green, Horsham, West Sussex, RH13 0JX.
Guide Price £400,000 Freehold

MARTIN&CO

- Village Location
- Three Bedrooms
- Spacious Living/dining room
- Private South Aspect Garden
- Bathroom and Separate WC

A beautifully presented and spacious three bedroom home set within a quiet cul- de- sac in Barns Green. The property offers a modern kitchen, a sunny south- facing rear garden, garage, off- street parking, and convenient access to local amenities.

Barns Green is consistently one of the area's most sought after villages, known for its strong community feel, village shop, well regarded local schooling and access to open countryside, while still offering convenient links into Horsham and the wider West Sussex area. It provides a balance that appeals to families and buyers looking for village living without feeling cut off.

The accommodation features an entrance hall with an internal door to the garage and access to the bright, double- aspect living/dining room. From here, double patio doors open into the sunroom, creating an additional versatile space. The modern fitted kitchen includes an attractive tiled splash back, built- in oven and hob, space for a washing machine, and a useful under- stairs cupboard. A further door leads directly out to the patio area.



Stairs lead to the first floor, where there are two generously sized double bedrooms, both featuring built- in wardrobes. The third bedroom could be used as a study and enjoys a pleasant outlook to the front,

The family bathroom has been beautifully redecorated, showcasing stylish modern tiles and a white fitted suite comprising a bath and shower. The separate WC has also been recently refreshed and features an attractive wood- effect wallpaper.

Outside, the rear garden enjoys a sunny southerly aspect and features a decked patio alongside a neatly lawned area. A gate at the far end of the garden provides convenient rear access.

To the front of the property, there is a generous driveway providing parking for several vehicles, along with access to the garage.

Should a purchaser have an offer accepted on a property marketed by Martin & Co, they will need to undertake an identification check. This is done to meet our obligation under Anti Money Laundering Regulations and is a legal requirement. We use an online service to verify your identity.

EPC C





Ground Floor

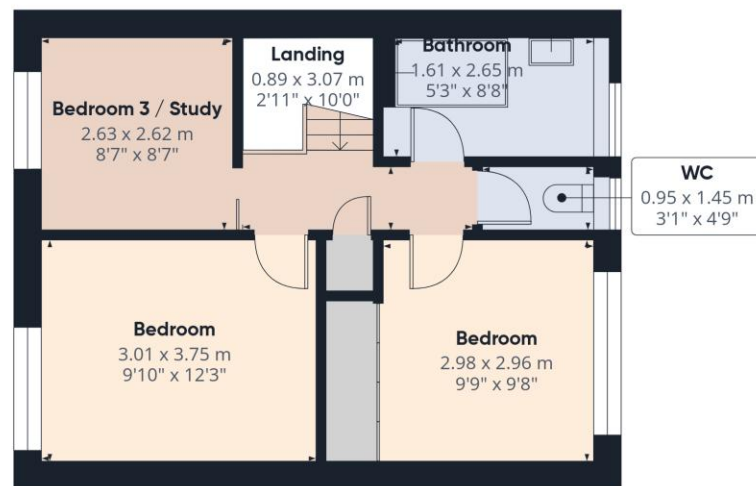

Floor 1



Approximate total area^m

97.5 m²
1048 ft²

Reduced headroom

0.6 m²
6 ft²

(1) Excluding balconies and terraces

Reduced headroom

..... Below 1.5 m/5 ft

Calculations reference the RICS IPMS 3C standard. Measurements are approximate and not to scale. This floor plan is intended for illustration only.

GIRAFFE360

Martin & Co Horsham

Envision House • 5 North Street • Horsham • RH12 1XQ
T: 01403 248222 • E: horsham@martinco.com

01403 248222

<http://www.martinco.com>

Accuracy: References to the Tenure of a Property are based on information supplied by the Seller. The Agent has not had sight of the title documents. A Buyer is advised to obtain verification from their Solicitor. Items shown in photographs including but not limited to carpets, fixtures and fittings are not included unless specifically mentioned within the sales particulars. They may however be available by separate negotiation. Buyers must check the availability of any property and make an appointment to view before embarking on any journey to see a property. No person in the employment of the agent has any authority to make any representation about the property, and accordingly any information given is entirely without responsibility on the part of the agents, sellers(s) or lessors(s). Any property particulars are not an offer or contract, nor form part of one. **Sonic / Laser Tape:** Measurements taken using a sonic / laser tape measure may be subject to a small margin of error. **All Measurements:** All Measurements are Approximate. **Services Not tested:** The Agent has not tested any apparatus, equipment, fixtures and fittings or services and so cannot verify that they are in working order or fit for the purpose. A Buyer is advised to obtain verification from their Solicitor or Surveyor.