

FOR SALE



Jasmine Close, Woking
Offers In Excess Of £500,000

MARTIN&CO

Jasmine Close, Woking

Offers In Excess Of £500,000

- Semi Detached House
- Living Dining Room
- Four Bedrooms
- Integral Garage
- Fitted Kitchen

Four-Bedroom Semi-Detached Family Home – Conveniently Located Near Goldsworth Park Centre.

Four-Bedroom Semi-Detached Family Home – Conveniently Located Near Goldsworth Park Centre

Located in a sought-after residential area close to Goldsworth Park Centre, this well-presented four-bedroom semi-detached home offers spacious and versatile accommodation ideal for family living.

The ground floor features a bright and airy living/dining room with wooden flooring throughout, a modern fitted kitchen, and a convenient downstairs cloakroom. Upstairs, the property boasts four well-proportioned bedrooms and a contemporary family bathroom complete with a power shower.



Further benefits include an integral garage, off-road parking for two vehicles, and a private rear garden. Situated within easy reach of local schools, shops, and amenities, this property is perfect for those seeking both comfort and convenience.

Early viewing is highly recommended.



Score	Energy rating	Current	Potential
92+	A		
81-91	B		85 B
69-80	C	73 C	
55-68	D		
39-54	E		
21-38	F		
1-10	G		



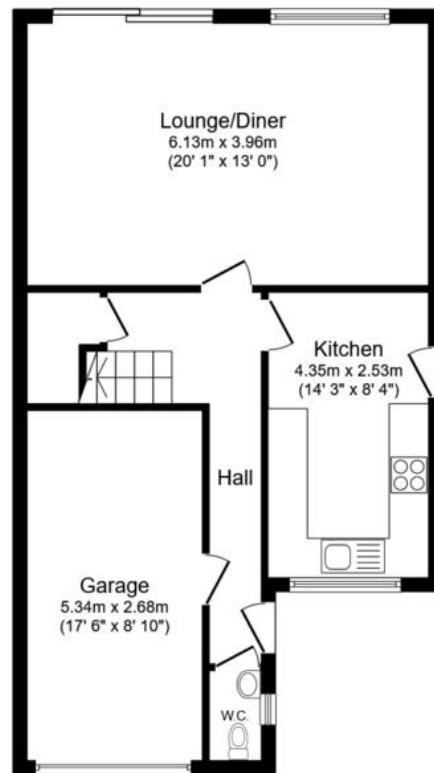

Ground Floor

Floor area 61.8 sq.m. (665 sq.ft.)

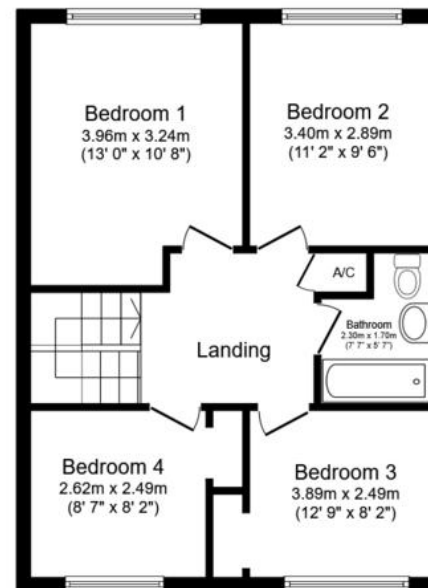

First Floor

Floor area 51.8 sq.m. (558 sq.ft.)

Total floor area: 113.6 sq.m. (1,223 sq.ft.)

Martin & Co Woking

35 Chertsey Road • • Woking • GU21 5AJ
T: 01483 727757 • E: woking@martinco.com

01483 727757

<http://www.martinco.com>



Accuracy: References to the Tenure of a Property are based on information supplied by the Seller. The Agent has not had sight of the title documents. A Buyer is advised to obtain verification from their Solicitor. Items shown in photographs including but not limited to carpets, fixtures and fittings are not included unless specifically mentioned within the sales particulars. They may however be available by separate negotiation. Buyers must check the availability of any property and make an appointment to view before embarking on any journey to see a property. No person in the employment of the agent has any authority to make any representation about the property, and accordingly any information given is entirely without responsibility on the part of the agents, sellers(s) or lessors(s). Any property particulars are not an offer or contract, nor form part of one. **Sonic / Laser Tape:** Measurements taken using a sonic / laser tape measure may be subject to a small margin of error. **All Measurements:** All Measurements are Approximate. **Services Not tested:** The Agent has not tested any apparatus, equipment, fixtures and fittings or services and so cannot verify that they are in working order or fit for the purpose. A Buyer is advised to obtain verification from their Solicitor or Surveyor.