

GROUND FLOOR
254 sq.ft. (23.6 sq.m.) approx.

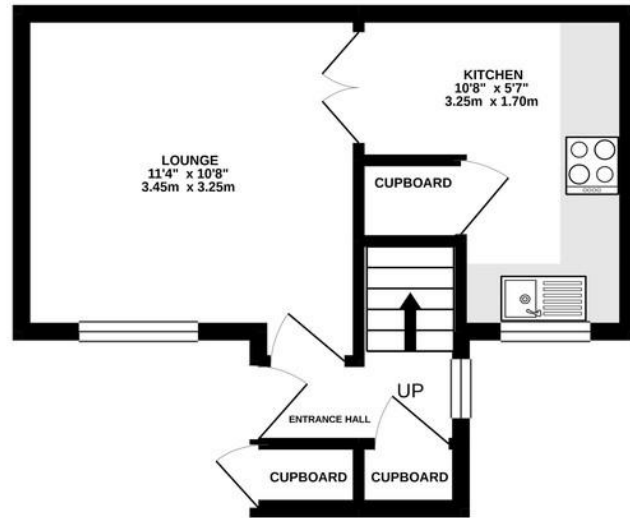

MARTIN&CO
1ST FLOOR
217 sq.ft. (20.2 sq.m.) approx.

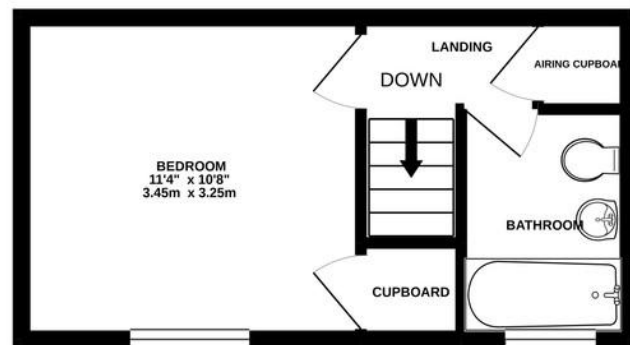

TOTAL FLOOR AREA: 472 sq.ft. (43.8 sq.m.) approx.

Whilst every attempt has been made to ensure the accuracy of the floorplan contained here, measurements of doors, windows, rooms and any other items are approximate and no responsibility is taken for any error, omission or mis-statement. This plan is for illustrative purposes only and should be used as such by any prospective purchaser. The services, systems and appliances shown have not been tested and no guarantee as to their operability or efficiency can be given.
Made with Metropix ©2021

TO LET



Martin & Co Basingstoke

26 London Street • Basingstoke • RG21 7PG
T: 01256-859960 • E: basingstoke@martinco.com

01256-859960

<http://www.martinco.com>



Accuracy: References to the Tenure of a Property are based on information supplied by the Seller. The Agent has not had sight of the title documents. A Buyer is advised to obtain verification from their Solicitor. Items shown in photographs including but not limited to carpets, fixtures and fittings are not included unless specifically mentioned within the sales particulars. They may however be available by separate negotiation. Buyers must check the availability of any property and make an appointment to view before embarking on any journey to see a property. No person in the employment of the agent has any authority to make any representation about the property, and accordingly any information given is entirely without responsibility on the part of the agents, sellers(s) or lessors(s). Any property particulars are not an offer or contract, nor form part of one. **Sonic / Laser Tape:** Measurements taken using a sonic / laser tape measure may be subject to a small margin of error. **All Measurements:** All Measurements are Approximate. **Services Not tested:** The Agent has not tested any apparatus, equipment, fixtures and fittings or services and so cannot verify that they are in working order or fit for the purpose. A Buyer is advised to obtain verification from their Solicitor or Surveyor.



Hatch Warren

1 Bedroom, 1 Bathroom, Back to Back House

£1,050 pcm





Hatch Warren

Back to Back House,
1 bedroom, 1 bathroom

£1,050 pcm

Date available: 3rd June 2025

Deposit: £1,211

Unfurnished

Council Tax band: B

- Terraced House
- One Bedroom
- 11ft Lounge
- Modern Kitchen
- Front Garden
- Bathroom
- One Allocated Parking Space

A one bedroom house located in the popular Hatch Warren area of Basingstoke offering an 11ft lounge, modern kitchen, double bedroom and bathroom. The property also benefits from double glazed windows, a front garden and one allocated parking space. Walkthrough Video available.

ENTRANCE HALL Stairs to first floor, storage cupboard, side aspect window and door to lounge

LOUNGE 11' 3" x 10' 7" (3.45m x 3.25m) Double glazed window, wood effect flooring, storage heater and double doors to

RE-FITTED KITCHEN 10' 7" x 5' 6" (3.25m x 1.70m) Double glazed window. Stainless steel sink unit with mixer taps with single drainer with single cupboard under. Further range of matching cupboards and drawers. Electric oven, washing machine, fridge, freezer and dishwasher and part-tiled walls

LANDING Airing cupboard

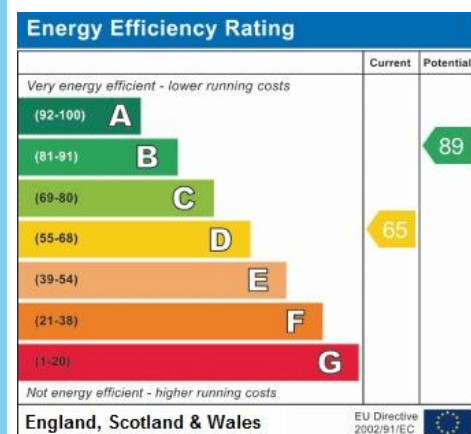

BEDROOM 11' 3" x 10' 7" (3.45m x 3.25m) Double glazed window, storage heater and cupboard

BATHROOM Double glazed window. Panelled enclosed bath, pedestal wash hand basin and low-level W.C

FRONT GARDEN Large front garden which is laid to lawn. The wooden shed will be removed and not replaced.

PARKING Parking space for 1 car

APPLICATIONS A holding deposit equivalent to 1 weeks rent will be required to reserve the property while referencing checks are being carried out. With the tenants' consent this holding deposit will be refunded against the first month's rent. The holding deposit can be retained if the applicant provides false or misleading information, fails Right to Rent checks, withdraws from the property or fails to take reasonable steps to enter into the tenancy.

In accordance with the Tenant Fees Act applicants will be required to enter into the tenancy agreement no more than 15 days after paying the holding deposit. Failure to do so for any of the afore mentioned reasons may result in you losing your holding deposit. An extension to the deadline may be entered into if agreed in writing by all parties.



Right to Rent Checks

By law, Right to Rent checks must be carried and as such will be required to provide proof of ID and address in accordance with Home Office guidelines. More information can be found at:

https://assets.publishing.service.gov.uk/government/uploads/system/uploads/attachment_data/file/573057/6_1193_HO_NH_Right-to-Rent-Guidance.pdf

Reference Checks and Credit Worthiness

All applicants will be subject to a credit check carried out by a 3rd party to check for CCJs and IVAs Applicants will need to provide proof of an income of at least 2.5 x annual rent.

We will also carry out employment checks, affordability checks, previous landlord reference and proof of address history, usually up to 3 years.

Documentation that will be required

Passport, driving licence, utility bill dated in the last 3 months (for proof of address) and payslips.

KEY FACTS FOR RENTERS

Council Tax Band: B

Basingstoke and Deane

EPC Rating: D

Minimum Tenancy Term: 12 Months

Parking for 1 car

UNFURNISHED