

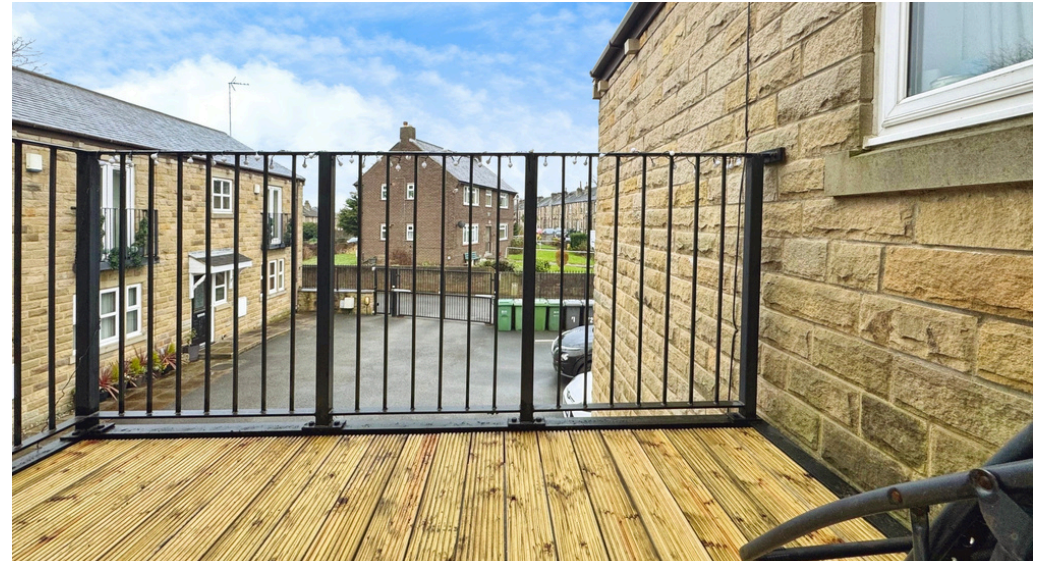

***** AVAILABLE JUNE 2025 *** EXCLUSIVE GATED DEVELOPMENT
CLOSE TO LOCAL AMENITIES *** two bedroom FIRST floor flat in
an just off Farsley Town Street.**

MARTIN & CO
Old Fold, Farsley, LS28 5BD
Offers Over £160,000

This inviting two-bedroom flat, ideal for first-time buyers or investors, features a unique open-plan layout, modern kitchen, and convenient access to local amenities, schools, and public transport in a sought-after location, with nearby parks enhancing its appeal.





Apartment



2



1



1



Allocated
Parking



Council
Band - B



D



LEASEHOLD

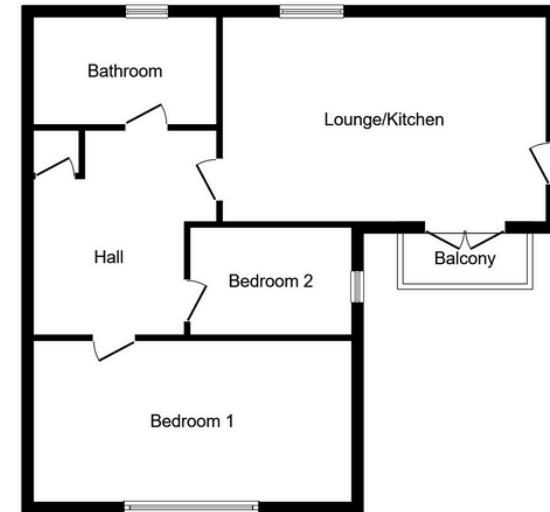

Floor Plan

Floor area 66.8 m² (719 sq.ft.)

TOTAL: 66.8 m² (719 sq.ft.)

This floor plan is for illustrative purposes only. It is not drawn to scale. Any measurements, floor areas (including any total floor area), openings and orientations are

We are delighted to present this inviting two-bedroom flat, currently for sale. This property is in a good condition and offers a unique open-plan structure, ideal for first-time buyers or potential investors.

The flat comprises of two generously sized bedrooms, a welcoming reception room, and a bathroom that has been maintained to a good standard. The open-plan kitchen is a standout feature of this property, providing a modern and spacious area for everyday cooking and dining.

The property is equipped with an energy performance certificate (EPC) rating of D and falls under the Council Tax Band B, providing a clear indication of the potential running costs.

This property is situated in a highly sought-after location. It is well positioned for access to local amenities, making daily errands convenient. For those with children, the flat is situated near various schools, simplifying the school run. It also has excellent public transport links, providing easy access to surrounding areas.

For those who value outdoor activities, nearby parks and walking routes are a bonus, providing plenty of opportunities for leisurely strolls or active jogs.

In summary, this flat is a great opportunity for both first-time buyers looking to get on the property ladder or investors seeking a property in a prime location. This property's open-plan style, coupled with its location and amenities, makes it a desirable choice. Viewing is highly recommended to fully appreciate the potential of this property.

