



Welcome to The Hollies, a charming Two-bedroom cottage nestled in the picturesque village of Bramhope, Leeds. Perfectly suited for first-time buyers, this delightful home effortlessly combines character and comfort, making it an ideal choice for those looking to settle in a beautiful location.

The Hollies is not just a property; it's a lifestyle. With its blend of original features and modern comforts, this cottage is ready to welcome you home.









The spacious living area is perfect for relaxation and entertaining, with ample natural light flooding through the windows, enhancing the cottage's inviting ambiance. The two well-proportioned bedrooms offer peaceful retreats for rest and relaxation, while the quaint bathroom provides modern amenities in a charming setting.

As you step inside, you are greeted by a warm and inviting atmosphere. The cottage boasts original features that add to its unique charm, including stunning wooden beams that grace the ceilings and a beautiful cast iron range oven that serves as a focal point in the cozy kitchen. These timeless elements create a sense of history and warmth, inviting you to make lasting memories.





Outside, you benefit from a communal yard that is accessed through the gate at the side and also have a road-side patio area at the front.

The picturesque surroundings of Bramhope offer a tranquil escape from the hustle and bustle of city life. Enjoy leisurely strolls through the scenic countryside, or take advantage of the local amenities that are just a stone's throw away. With its beautiful landscapes and friendly community, Bramhope is a perfect place to call home.



2



1



Street Parking



Council Tax = E



1



Freehold



End Terraced



D



879 SQFT





View to the right (approx.)

View to the left (approx.)

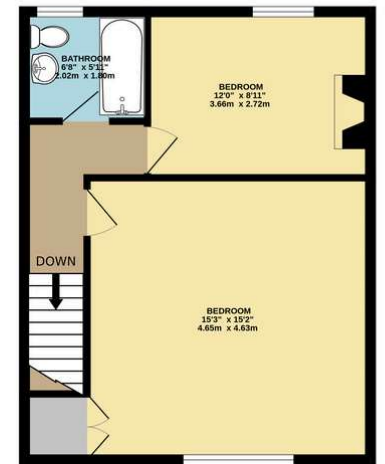
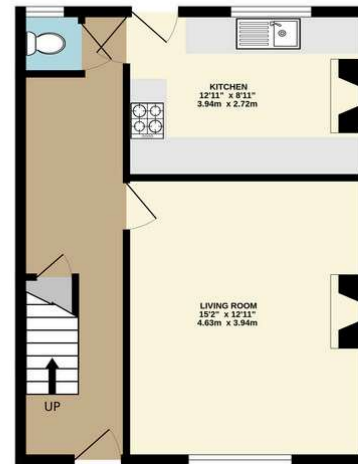

TOTAL FLOOR AREA: 879 sq. ft. (81.6 sq. m.) approx.
 Whilst every attempt has been made to ensure the accuracy of the floorplan contained herein, measurements

