



This three-bedroom terraced house, offers an excellent opportunity for first-time buyers or investors to transform it into a dream home, thanks to its superb location near amenities and public transport.

MARTIN & CO

3 Springfield Close
£225,000





Mid-Terraced



3



1



1



On-Street Band - B



EPC - D



FLYING FREEHOLD



683sqft



Presenting a terraced house for sale that provides an excellent opportunity for those seeking to put their stamp on a property. This residence is in need of modernisation, offering potential buyers an exciting chance to reimagine the space.

The property currently comprises three bedrooms, a single bathroom, one reception room and a kitchen. Despite requiring updates, the house boasts a well-structured layout that can be easily enhanced to accommodate a modern lifestyle.

This property is situated in a superb location, with access to local amenities. It is also conveniently located near public transport links and a variety of local schools, making it a perfect choice for families.

This terraced house is rated D on the Energy Performance Certificate (EPC), indicating that there's scope for improvement in terms of energy efficiency. The property falls under the council tax band B, which is relatively low and hence, financially advantageous, flying freehold.

This property is an excellent prospect for first-time buyers who are looking to make a house their home. It also presents a lucrative investment opportunity due to its promising potential for enhancement and its desirable location.

In summary, this terraced house is not just a property, but a project filled with potential. Its location, size, and layout make it a promising opportunity for both first-time buyers and investors. All it needs is a vision and a touch of modernisation to transform it into a dream home. Please do not hesitate to get in touch to arrange a viewing or for more information.

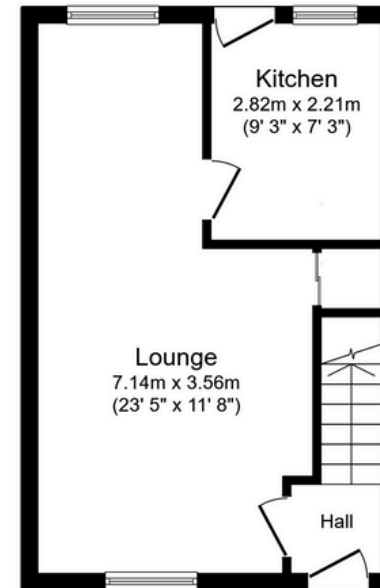

Ground Floor
Floor area 31.7 m² (341 sq.ft.)

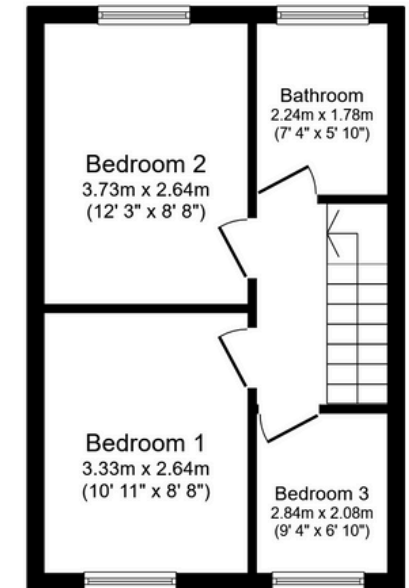

First Floor
Floor area 31.7 m² (341 sq.ft.)

3.4 m² (683 sq.ft.)

For illustrative purposes only. It is not drawn to scale. Any measurements, floor areas (including any total floor area), openings and orientations are details are guaranteed, they cannot be relied upon for any purpose and do not form any part of any agreement. No liability is taken for any error, omission or party must rely upon its own inspection(s). Powered by www.Propertybox.io