

**TO LET**



## **7 Halfway Close**

**4 Bedrooms, 3 Bathroom, End Town House**

**£895 pcm**



## 7 Halfway Close

End Town House,  
4 bedroom, 3 bathroom

£895 pcm

Date available: 27th November 2024

Deposit: £1,032

Unfurnished

Council Tax band: C

- Allocated Parking
- Close To School
- Enclosed Garden Area
- Close to Transport Links
- Modern decor
- 
- 

Modern 4-Bedroom town house in Goldthorpe.

Situated in a popular area, boasting excellent transport links and close to school and local amenities, this beautifully presented 4-bedroom townhouse is perfect for families seeking comfort and convenience.

The property boasts a generous living area with modern decor throughout. There is a family bathroom plus an en-suite to the master bedroom and there is an enclosed rear garden. The property also has its own allocated parking.

Contact us today to schedule a viewing!

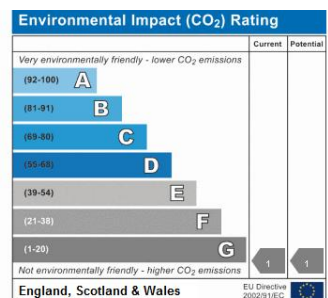
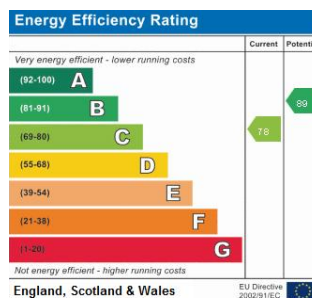

Address:  
Halfway Close Goldthorpe 21 9TH LE11 1-63 9PH

Reference:  
Halfway Close



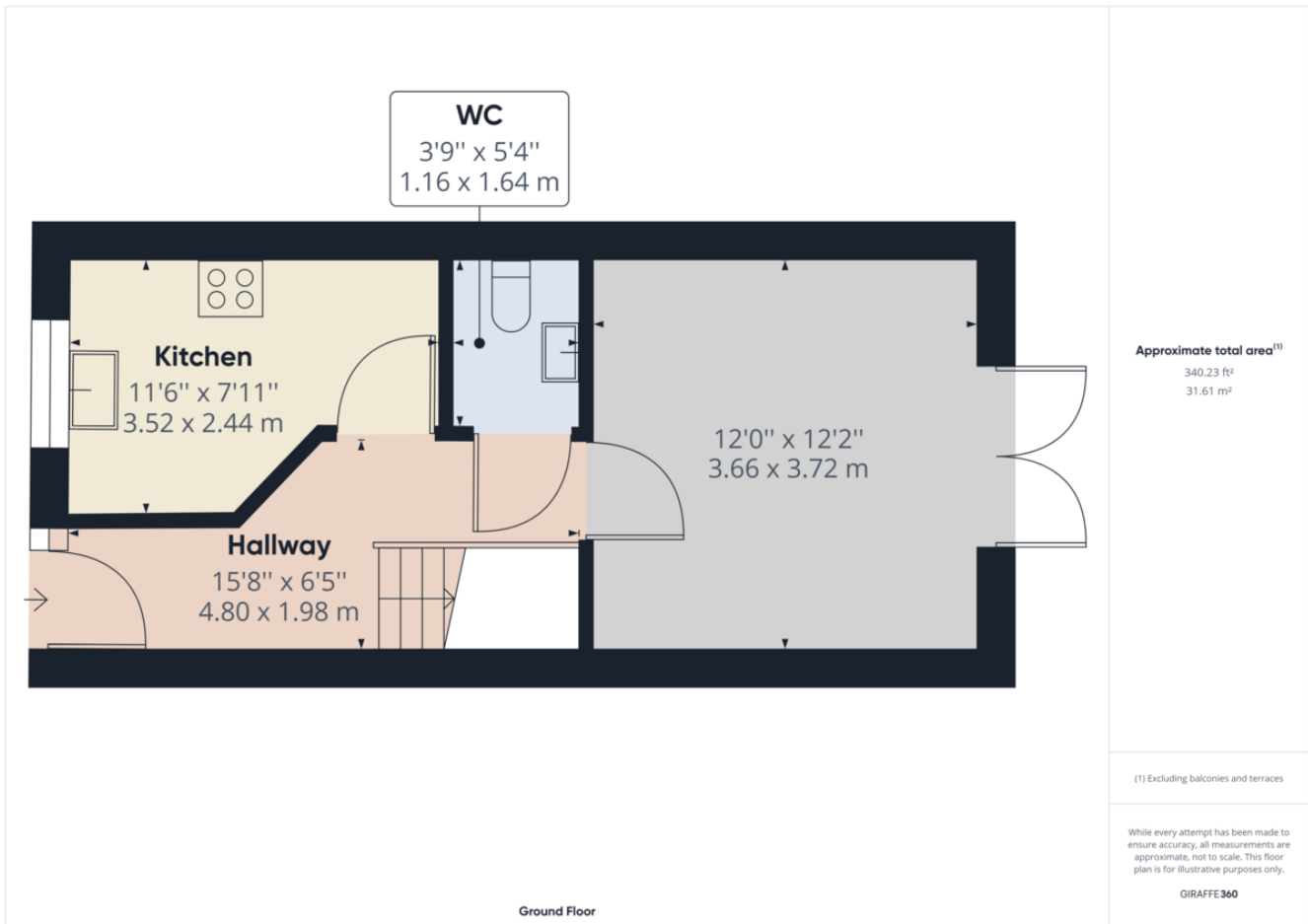

## Martin & Co Rotherham

5 Worry Goose Lane • Whiston • Rotherham • S60 4AA

T: 01709 544982 • E: rotherham@martinco.com

# 01709 544982

<http://www.martinco.com>



**Accuracy:** References to the Tenure of a Property are based on information supplied by the Seller. The Agent has not had sight of the title documents. A Buyer is advised to obtain verification from their Solicitor. Items shown in photographs including but not limited to carpets, fixtures and fittings are not included unless specifically mentioned within the sales particulars. They may however be available by separate negotiation. Buyers must check the availability of any property and make an appointment to view before embarking on any journey to see a property. No person in the employment of the agent has any authority to make any representation about the property, and accordingly any information given is entirely without responsibility on the part of the agents, sellers(s) or lessors(s). Any property particulars are not an offer or contract, nor for part of one. **Sonic / laser Tape:** Measurements taken using a sonic / laser tape measure may be subject to a small margin of error. **All Measurements:** All Measurements are Approximate. **Services Not tested:** The Agent has not tested any apparatus, equipment, fixtures and fittings or services and so cannot verify that they are in working order or fit for the purpose. A Buyer is advised to obtain verification from their Solicitor or Surveyor.