

TO LET



Mayfield Road , Southampton

5 Bedrooms, 3 Bathroom, Semi-Detached House

£2,700 pcm



Mayfield Road , Southampton

Semi-Detached House,
5 bedroom, 3 bathroom

£2,700 pcm

Date available: 22nd June 2026

Deposit: £3,115.38

Furnished

Council Tax band: B

- STUDENT ACCOMMODATION
- High standard, furnished
- Modern Kitchens and bathrooms
- Appliances included
- Deposit £3115.38, EPC rate D
- Prime location with garden - On Road parking
- Walking distance to Southampton Uni

Martin & Co are pleased to present this 5 bedroom HMO licenced STUDENT ACCOMMODATION. High standard with modern fixtures and fittings. Modern Kitchen and bathrooms, bedrooms include new furniture from ikea. (Bills not included)

BEDROOMS

BACK DOWNSTAIRS BEDROOM WITH ENSUITE

FRONT BEDROOM DOWNSTAIRS

3-5 BEDROOMS UPSTAIRS

Living space large reception leading to garden

Kitchen

Two main bathrooms in addition to the ensuite

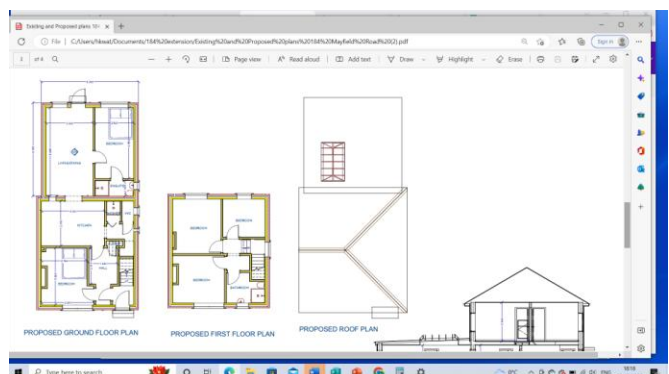



Garden



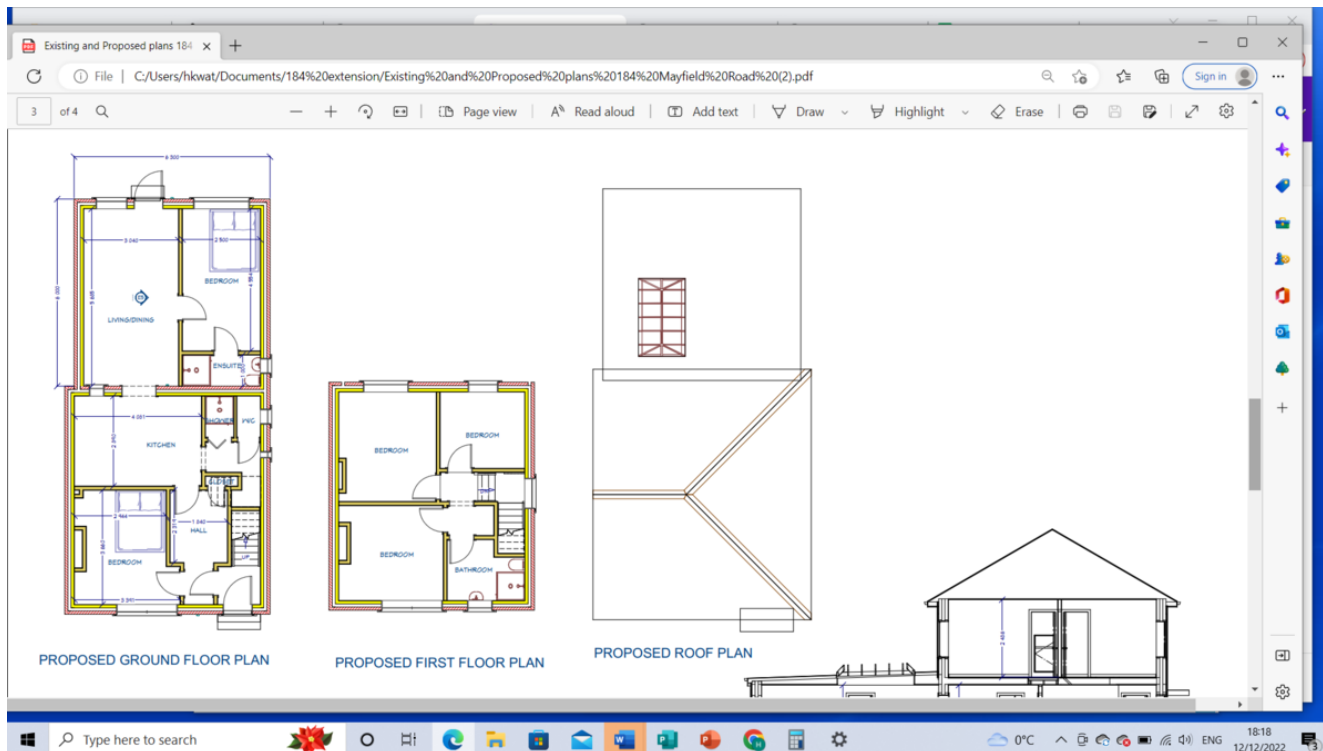

Martin & Co Southampton City **02380 988881**
46 London Road • Southampton • SO15 2AH
T: 02380 988881 • E: southamptoncity@martinco.com <http://www.martinco.com>



Accuracy: References to the Tenure of a Property are based on information supplied by the Seller. The Agent has not had sight of the title documents. A Buyer is advised to obtain verification from their Solicitor. Items shown in photographs including but not limited to carpets, fixtures and fittings are not included unless specifically mentioned within the sales particulars. They may however be available by separate negotiation. Buyers must check the availability of any property and make an appointment to view before embarking on any journey to see a property. No person in the employment of the agent has any authority to make any representation about the property, and accordingly any information given is entirely without responsibility on the part of the agents, sellers(s) or lessors(s). Any property particulars are not an offer or contract, nor for part of one. **Sonic / laser Tape:** Measurements taken using a sonic / laser tape measure may be subject to a small margin of error. **All Measurements:** All Measurements are Approximate. **Services Not tested:** The Agent has not tested any apparatus, equipment, fixtures and fittings or services and so cannot verify that they are in working order or fit for the purpose. A Buyer is advised to obtain verification from their Solicitor or Surveyor.