



Home Report

shepherd.co.uk



SHEPHERD

CHARTERED SURVEYORS

All Angles Covered

Residential | Commercial | Property & Construction



Contents

1. Scottish Single Survey
 2. Energy Performance Certificate
 3. Property Questionnaire
 4. Appendices
-



Scottish Single Survey



Single Survey

survey report on:

Property address	362g Strathmore Avenue Dundee DD3 6RU
Customer	Peter & Anne Turrell
Customer address	362g Strathmore Avenue Dundee DD3 6RU
Prepared by	Shepherd Chartered Surveyors
Date of inspection	17/03/2025



www.shepherd.co.uk

PART 1 - GENERAL

1.1 THE SURVEYORS

The Seller has engaged the Surveyors to provide the Single Survey Report and a generic Mortgage Valuation Report for Lending Purposes. The Seller has also engaged the Surveyors to provide an Energy Report in the format prescribed by the accredited Energy Company.

The Surveyors are authorised to provide a transcript or retype of the generic Mortgage Valuation Report on to Lender specific pro-forma. Transcript reports are commonly requested by Brokers and Lenders. The transcript report will be in the format required by the Lender but will contain the same information, inspection date and valuation figure as the generic Mortgage Valuation Report and the Single Survey. The Surveyors will decline any transcript request which requires the provision of information additional to the information in the Report and the generic Mortgage Valuation Report until the Seller has conditionally accepted an offer to purchase made in writing.

Once the Seller has conditionally accepted an offer to purchase made in writing, the Purchaser's lender or conveyancer may request that the Surveyors provide general comment on standard appropriate supplementary documentation. In the event of a significant amount of documentation being provided to the Surveyors, an additional fee may be incurred by the Purchaser. Any additional fee will be agreed in writing.

If information is provided to the Surveyors during the conveyancing process which materially affects the valuation stated in the Report and generic Mortgage Valuation Report, the Surveyors reserve the right to reconsider the valuation. Where the Surveyors require to amend the valuation in consequence of such information, they will issue an amended Report and generic Mortgage Valuation Report to the Seller. It is the responsibility of the Seller to ensure that the amended Report and generic Mortgage Valuation Report are transmitted to every prospective Purchaser.

The individual Surveyor will be a member of the Royal Institution of Chartered Surveyors who is competent to survey, value and report upon Residential Property¹.

If the Surveyors have had a previous business relationship within the past two years with the Seller or Seller's Agent or relative to the property, they will be obliged to indicate this by marking the adjacent box.

☐

The Surveyors have a written complaints handling procedure. This is available from the offices of the Surveyors at the address stated.

1.2 THE REPORT

The Surveyors will not provide an amended Report on the Property, except to correct factual inaccuracies.

The Report will identify the nature and source of information relied upon in its preparation.

The Surveyor shall provide a Market Value of the Property, unless the condition of the Property is such that it would be inappropriate to do so. A final decision on whether a loan will be granted rests with the Lender who may impose retentions in line with their lending criteria. The date of condition and value of the property will be the date of inspection.

Prior to 1 December 2008, Purchasers have normally obtained their own report from their chosen Surveyor. By contrast, a Single Survey is instructed by the Seller and made available to all potential Purchasers in expectation that the successful Purchaser will have relied upon it. The Royal Institution of Chartered Surveyors rules require disclosure of any potential conflict of interest when acting for the Seller and the Purchaser in the same transaction. The Single Survey may give rise to a conflict of interest and if this is of concern to any party they are advised to seek their own independent advice.

The Report and any expressions or assessments in it are not intended as advice to the Seller or Purchaser or any other person in relation to an asking price or any other sales or marketing decisions.

¹ Which shall be in accordance with the current RICS Valuation Standards (The Red Book) and RICS Rules of Conduct.

The Report is based solely on the Property and is not to be relied upon in any manner whatsoever when considering the valuation or condition of any other property.

If certain minor matters are mentioned in the Report it should not be assumed that the Property is free of other minor defects.

Neither the whole nor any part of the Report may be published in any way, reproduced or distributed by any party other than the Seller, prospective purchasers and the Purchaser and their respective professional advisers without the prior written consent of the Surveyors.

1.3 LIABILITY

The Report is prepared with the skill and care reasonably to be expected of a competent residential surveyor who is a member of the Royal Institution of Chartered Surveyors.

The Report is addressed to the Seller and was prepared in the expectation that it (or a complete copy) along with these Terms and Conditions (or a complete copy) would (or, as the case might be, would have been) be disclosed and delivered to:

- the Seller;
- any person(s) noting an interest in purchasing the Property from the Seller;
- any person(s) who make(s) (or on whose behalf is made) an offer to purchase the Property, whether or not that offer is accepted by the Seller;
- the Purchaser; and
- the professional advisers of any of these.

The Surveyors acknowledge that their duty of skill and care in relation to the Report is owed to the Seller and to the Purchaser. The Surveyors accept no responsibility or liability whatsoever in relation to the Report to persons other than the Seller and the Purchaser. The Seller and Purchaser should be aware that if a Lender seeks to rely on this Report they do so at their own risk. In particular, the Surveyors accept no responsibility or liability whatsoever to any Lender in relation to the Report. Any such Lender relies upon the Report entirely at their own risk.

1.4 GENERIC MORTGAGE VALUATION REPORT

The Surveyors undertake to the Seller that they will prepare a generic Mortgage Valuation Report, which will be issued along with the Single Survey. It is the responsibility of the Seller to ensure that the generic Mortgage Valuation Report is provided to every potential Purchaser.

1.5 TRANSCRIPT MORTGAGE VALUATION FOR LENDING PURPOSES

The Surveyors undertake that on being asked to do so by a prospective purchaser, or his/her professional advisor or Lender, they will prepare a Transcript Mortgage Valuation Report for Lending Purposes on terms and conditions to be agreed between the Surveyors and Lender and solely for the use of the Lender and upon which the Lender may rely. The decision as to whether finance will be provided is entirely a matter for the Lender. The Transcript Mortgage Valuation Report will be prepared from information contained in the Report and the generic Mortgage Valuation Report².

1.6 INTELLECTUAL PROPERTY

All intellectual property rights whatsoever (including copyright) in and to the Report, excluding the headings and rubrics, are the exclusive property of the Surveyors and shall remain their exclusive property unless

² Which shall be in accordance with the current RICS Valuation Standards (The Red Book) and RICS Rules of Conduct.

they assign the same to any other party in writing.

1.7 PAYMENT

The Surveyors are entitled to refrain from delivering the Report to anyone until the fee and other charges for it notified to the Seller have been paid. Additional fees will be charged for subsequent inspections and Reports.

1.8 CANCELLATION

The Seller will be entitled to cancel the inspection by notifying the Surveyor's office at any time before the day of the inspection.

The Surveyor will be entitled not to proceed with the inspection (and will so report promptly to the Seller) if after arriving at the property, the Surveyor concludes that it is of a type of construction of which the Surveyor has insufficient specialist knowledge to be able to provide the inspection satisfactorily. The Surveyor will also be entitled not to proceed if after arriving at the property, the surveyor concludes that the property is exempt under Part 3 of The Housing (Scotland) Act 2006 as detailed in the (Prescribed Documents) Regulations 2008. If there is a potential threat to their health or personal safety, the inspection may be postponed or cancelled, at the Surveyor's discretion.

In the case of cancellation or the inspection not proceeding, the Surveyor will refund any fees paid by the Seller for the inspection and Report, except for expenses reasonably incurred and any fee due in light of the final paragraph of this section.

In the case of cancellation by the Seller, for whatever reason, after the inspection has taken place but before a written report is issued, the Surveyor will be entitled to raise an invoice equivalent to 80% of the agreed fee.

1.9 PRECEDENCE

If there is any incompatibility between these Terms and Conditions and the Report, these Terms and Conditions take precedence.

1.10 DEFINITIONS

- the "Lender" is the party who has provided or intends or proposes to provide financial assistance to the Purchaser towards the purchase of the Property and in whose favour a standard security will be granted over the Property;
- the "Transcript Mortgage Valuation Report for Lending Purposes" means a separate report, prepared by the Surveyor, prepared from information in the Report and the generic Mortgage Valuation Report, but in a style and format required by the Lender. The Transcript Mortgage Valuation Report for Lending Purposes will be prepared with the skill and care reasonably to be expected from a surveyor who is a member of the Royal Institution of Chartered Surveyors and who is competent to survey, value and report on the Property;
- the "Generic Mortgage Valuation Report" means a separate report, prepared by the Surveyor from information in the Report but in the Surveyor's own format;
- the "Market Value" is the estimated amount for which a property should exchange on the date of valuation between a willing buyer and a willing seller in an arm's-length transaction after proper marketing wherein the parties had each acted knowledgeably, prudently and without compulsion;
- the "Property" is the property which forms the subject of the Report;
- the "Purchaser" is the person (or persons) who enters into a contract to buy the Property from the Seller;

- a "prospective Purchaser" is anyone considering buying the Property;
- the "Report" is the report, of the kind described in Part 2 of these Terms and Conditions and in the form set out in part 1 of Schedule 1 of the Housing (Scotland) Act 2006 (Prescribed Documents) Regulations 2008;
- the "Seller" is/are the proprietor(s) of the Property;
- the "Surveyor" is the author of the Report on the Property; and
- the "Surveyors" are the firm or company of which the Surveyor is an employee, director, member or partner (unless the Surveyor is not an employee, director, member or partner, when the "Surveyors" means the Surveyor) whose details are set out at the head of the Report.
- the "Energy Report" is the advice given by the accredited Energy Company, based on information collected by the Surveyor during the Inspection, and also includes an Energy Performance Certificate, in a Government approved format.

PART 2 - DESCRIPTION OF THE REPORT

2.1 THE SERVICE

The Single Survey is a Report by an independent Surveyor, prepared in an objective way regarding the condition and value of the Property on the day of the inspection, and who is a member of the Royal Institution of Chartered Surveyors. It includes an Energy Report as required by Statute and this is in the format of the accredited Energy Company. In addition, the Surveyor has agreed to supply a generic Mortgage Valuation Report.

2.2 THE INSPECTION

The Inspection is a general surface examination of those parts of the Property which are accessible: in other words, *visible and readily available for examination from ground and floor levels, without risk of causing damage to the Property or injury to the Surveyor.*

All references to visual inspection refer to an inspection from within the property at floor level and from ground level within the site and adjoining public areas, without the need to move any obstructions. Any references to left or right are taken facing the front of the property.

The Inspection is carried out with the Seller's permission, without causing damage to the building or contents. Furniture, stored items and insulation are not moved.

Unless identified in the report the Surveyor will assume that no harmful or hazardous materials have been used in the construction. The presence or possible consequences of any site contamination will not be researched.

The Surveyor will not carry out an asbestos inspection, and will not be acting as an asbestos inspector in completing a Single Survey of properties that may fall within the Control of Asbestos in the Workplace Regulations. In the case of flats it will be assumed that there is a duty holder, as defined in the Regulations and that a Register of Asbestos and effective Management Plan is in place, which does not require any expenditure, or pose a significant risk to health. No enquiry of the duty holder will be made.

2.3 THE REPORT

The Report will be prepared by the Surveyor who carried out the property inspection and will describe various aspects of the property as defined by the headings of the Single Survey report with the comments

being general and unbiased. The report on the location, style and condition of the property, will be concise and will be restricted to matters that could have a material effect upon value and will omit items that, in the Surveyor's opinion, are not significant. If certain minor matters are mentioned, it should not be interpreted that the property is free of any other minor defects.

Throughout the Report, the following repair categories will be used to give an overall opinion of the state of repair and condition of the property.

- 1 Category 3: Urgent repairs or replacement are needed now. Failure to deal with them may cause problems to other parts of the property or cause a safety hazard. Estimates for repairs or replacement are needed now.
- 2 Category 2: Repairs or replacement requiring future attention, but estimates are still advised.
- 3 Category 1: No immediate action or repair is needed.

WARNING: If left unattended, even for a relatively short period, Category 2 repairs can rapidly develop into more serious Category 3 repairs. The existence of Category 2 or Category 3 repairs may have an adverse effect on marketability, value and the sale price ultimately achieved for the property. This is particularly true during slow market conditions when the effect can be considerable.

Parts of the property, which cannot be seen or accessed, will not be reported upon and this will be stated. If the Surveyor suspects that a defect may exist within an unexposed area and which could have a material effect upon the value, he may recommend further investigation by specialist contractors.

2.4 SERVICES

Surveyors are not equipped or qualified to test the services and therefore no comment can be interpreted as implying that the design, installation and function of the services are in accordance/compliance with regulations, safety and efficiency expectations. However, comment is made where there is cause to suspect significant defects or shortcomings with the installations. No tests are made of any services or appliances.

2.5 ACCESSIBILITY

A section is included to help identify the basic information interested parties need to know to decide whether to view a property.

2.6 ENERGY REPORT

A section is included that makes provision for an Energy Report, relative to the property. The Surveyor will collect physical data from the property and provide such data in a format required by an accredited Energy Company. The Surveyor cannot of course accept liability for any advice given by the Energy Company.

2.7 VALUATION AND CONVEYANCER ISSUES

The last section of the Report contains matters considered relevant to the Conveyancer (Solicitor). It also contains the Surveyor's opinion both of the market value of the property and of the re-instatement cost, as defined below.

"Market Value" The estimated amount for which a property should exchange on the date of valuation between a willing buyer and a willing seller in an arm's-length transaction after proper marketing wherein the parties had each acted knowledgeably, prudently and without compulsion. In arriving at the opinion of the Market Value the Surveyor also makes various standard assumptions covering, for example, vacant possession; tenure and other legal considerations; contamination and hazardous materials; the condition of un-inspected parts; the right to use mains services; and the exclusion of curtains, carpets etc. from the valuation. In the case of flats, the following further assumptions are made that:

- There are rights of access and exit over all communal roadways, corridors, stairways etc. and to use

Terms and Conditions

communal grounds, parking areas, and other facilities;

- There are no particularly troublesome or unusual legal restrictions;
- There is no current dispute between the occupiers of the flats or any outstanding claims or losses; and the costs of repairs to the building are shared among the co-proprietors on an equitable basis.

Any additional assumption, or any found not to apply, is reported.

"Re-instatement cost" *is an estimate for insurance purposes of the current cost of rebuilding the Property in its present form* unless otherwise stated. This includes the cost of rebuilding the garage and permanent outbuildings, site clearance and professional fees, but excludes VAT (except on the fees).

Sellers or prospective Purchasers may consider it prudent to instruct a reinspection and revaluation after a period of 12 weeks (or sooner if appropriate) to reflect changing circumstances in the market and/or in the physical condition of the Property.

1. Information and scope of inspection

This section tells you about the type, accommodation, neighbourhood, age and construction of the property. It also tells you about the extent of the inspection and highlights anything that the surveyor could not inspect.

All references to visual inspection refer to an inspection from within the property without moving any obstructions and externally from ground level within the site and adjoining public areas. Any references to left or right in a description of the exterior of the property refer to the view of someone standing facing that part of the property from the outside.

The inspection is carried out without causing damage to the building or its contents and without endangering the occupiers or the surveyor. Heavy furniture, stored items and insulation are not moved. Unless identified in the report the surveyor will assume that no harmful or hazardous materials or techniques have been used in the construction. The presence or possible consequences of any site contamination will not be researched.

Services such as TV/cable connection, internet connection, swimming pools and other leisure facilities etc. will not be inspected or reported on.

Description	Purpose built third floor left/east most flat forming part of a four storey mid terraced tenement.
Accommodation	THIRD FLOOR: Entrance Hallway, Lounge, 2 Bedrooms, Kitchen and Shower Room with WC.
Gross internal floor area (m²)	54 sq metres or thereby.
Neighbourhood and location	Situated in a mixed residential and commercial location one and a half miles north of Dundee City centre. Adequate public transport, shopping, social and educational facilities are available within easy reach.
Age	Erected around 1900.
Weather	Dry and overcast.
Chimney stacks	Visually inspected with the aid of binoculars where appropriate. Chimney stacks are of solid stone construction.

Single Survey

Roofing including roof space	<p>Sloping roofs were visually inspected with the aid of binoculars where appropriate.</p> <p>The roof is of pitched timber construction externally clad in slates with zinc ridging.</p> <p>Due to the presence of plaster board fire break partitions and the absence of suitable walk boards only an extremely limited head and shoulders inspection was possible of the mutual roof void from the hatch within the close. Insulation is laid at the joists.</p>
Rainwater fittings	<p>Visually inspected with the aid of binoculars where appropriate.</p> <p>PVC gutters and downpipes.</p>
Main walls	<p>Visually inspected with the aid of binoculars where appropriate.</p> <p>Foundations and concealed parts were not exposed or inspected.</p> <p>The main walls are of solid stone construction with the upper west gable harled.</p>
Windows, external doors and joinery	<p>Internal and external doors were opened and closed where keys were available.</p> <p>Random windows were opened and closed where possible.</p> <p>Doors and windows were not forced open.</p> <p>Windows are of mixed vintage UPVC double glazed design.</p> <p>There is a timber flush panel entrance door to the flat.</p>
External decorations	<p>Visually inspected.</p> <p>Not applicable - maintenance free PVC.</p>
Conservatories / porches	<p>None.</p>
Communal areas	<p>Circulation areas visually inspected.</p> <p>Access to all flats is via a mutual close and stairwell.</p>

Single Survey

Garages and permanent outbuildings	<p>Visually inspected.</p> <p>Outbuildings comprise a series of former bin stores of brick and concrete construction.</p>
Outside areas and boundaries	<p>Visually inspected.</p> <p>To the rear is a mutual drying area bounded by the neighbouring industrial properties, stone walls and timber fencing.</p>
Ceilings	<p>Visually inspected from floor level.</p> <p>Ceilings are of lath and plaster and plasterboard construction. Surfaces have been paper and painted, there is a textured finish in the lounge and PVC cladding in the shower room.</p>
Internal walls	<p>Visually inspected from floor level.</p> <p>Using a moisture meter, walls were randomly tested for dampness where considered appropriate.</p> <p>Internal partitions would appear to be of timber lath and plaster and timber stud and plasterboard. Surfaces have been paper and painted and there is full tiling within the shower room.</p>
Floors including sub floors	<p>Surfaces of exposed floors were visually inspected. No carpets or floor coverings were lifted.</p> <p>Floors are of suspended timber overlaid in tongue and groove boarding.</p> <p>Due to fitted floor coverings throughout no inspection was at all possible of the floors.</p>
Internal joinery and kitchen fittings	<p>Built-in cupboards were looked into but no stored items were moved.</p> <p>Kitchen units were visually inspected excluding appliances.</p> <p>Base and wall kitchen fitments.</p> <p>Internal doors are of timber flush panel design.</p>

Single Survey

Chimney breasts and fireplaces	<p>Visually inspected.</p> <p>No testing of the flues or fittings was carried out.</p> <p>There is a gas fire in the lounge which is assumed to be vented into the chimney.</p>
Internal decorations	<p>Visually inspected.</p> <p>Paper and painted finish throughout.</p>
Cellars	<p>None.</p>
Electricity	<p>Accessible parts of the wiring were visually inspected without removing fittings. No tests whatsoever were carried out to the system or appliances. Visual inspection does not assess any services to make sure they work properly and efficiently and meet modern standards. If any services are turned off, the surveyor will state that in the report and will not turn them on.</p> <p>Mains supply of electricity serving the subjects with the meter and fuse box being located within the hall.</p>
Gas	<p>Accessible parts of the system were visually inspected without removing fittings. No tests whatsoever were carried out to the system or appliances. Visual inspection does not assess any services to make sure they work properly and efficiently and meet modern standards. If any services are turned off, the surveyor will state that in the report and will not turn them on.</p> <p>Mains supply of gas serving the subjects with the meter being located within the rear bedroom cupboard.</p>
Water, plumbing, bathroom fittings	<p>Visual inspection of the accessible pipework, water tanks, cylinders and fittings without removing any insulation.</p> <p>No tests whatsoever were carried out to the system or appliances.</p> <p>Mains supply of water and plumbing where seen is of copper and PVC.</p> <p>Sanitary fittings comprise a three piece shower room suite.</p>

Heating and hot water	<p>Visual inspection of the accessible pipework, water tanks, cylinders and fittings without removing any insulation.</p> <p>No tests whatsoever were carried out to the system or appliances.</p> <p>Gas central heating system fired by a wall mounted combination boiler located within the rear bedroom's cupboard. There are radiators throughout the main apartments which benefit from individually controlled thermostatic valves and central heating piping is of copper micro-bore construction.</p> <p>Hot water is assumed to be heated directly by the central heating boiler.</p>
Drainage	<p>Drainage covers etc. were not lifted.</p> <p>Neither drains nor drainage systems were tested.</p> <p>Assumed to be connected to the main sewer.</p>
Fire, smoke and burglar alarms	<p>Visually inspected.</p> <p>No tests whatsoever were carried out to the system or appliances.</p> <p>All Scottish homes require a smoke alarm to be installed in the room most frequently used for living purposes and in every circulation space on each floor. A heat alarm also needs to be installed in each kitchen. The alarms need to be ceiling mounted and interlinked. Where there is a carbon-fuelled appliance such as a boiler, open fire or wood burner, a carbon monoxide detector is also required. We have not assessed or tested any existing equipment and it is the purchasers responsibility to confirm that the property will comply with these standards following a change of ownership.</p>

Any additional limits to inspection	<p>For flats / maisonettes</p> <p>Only the subject flat and internal communal areas giving access to the flat were inspected.</p> <p>If the roof space or under-building / basement is communal, reasonable and safe access is not always possible. If no inspection was possible, this will be stated. If no inspection was possible, the surveyor will assume that there are no defects that will have a material effect on the valuation.</p> <p>The building containing the flat, including any external communal areas, was visually inspected only to the extent that the surveyor is able to give an opinion on the general condition and standard of maintenance.</p> <p>Due to fitted floor coverings throughout no inspection was at all possible of the floors or below kitchen or sanitary fittings.</p> <p>Windows were not all fully opened or tested.</p> <p>Due to the presence of plaster board fire break partitions and the absence of suitable walk boards only an extremely limited head and shoulders inspection was possible of the mutual roof void from the hatch within the close</p> <p>From ground level no view was possible of the roof coverings.</p> <p>An inspection for Japanese Knotweed was not carried out. This is a plant which is subject to control regulation, is considered to be invasive and one which can render a property unsuitable for some mortgage lenders. It is therefore assumed that there is no Japanese Knotweed within the boundaries of the property or its neighbouring property. Identification of Japanese Knotweed is best undertaken by a specialist contractor.</p>
--	---

Sectional Diagram showing elements of a typical house





Single Survey

2. Condition

This section identifies problems and tells you about the urgency of any repairs by using one of the following three categories:

Category 3	Category 2	Category 1
Urgent repairs or replacement are needed now. Failure to deal with them may cause problems to other parts of the property or cause a safety hazard. Estimates for repairs or replacement are needed now.	Repairs or replacement requiring future attention, but estimates are still advised.	No immediate action or repair is needed.

 Structural movement	
Repair category	1
Notes	Evidence of settlement/movement has affected the building reflected externally by general distortion to sills and lintels and a lean to the gable chimney head whilst internally there is a run in the flooring and plaster cracking particularly evident at the lounge cornicing. On the basis of a single inspection this appears longstanding with no evidence of recent movement apparent.

 Dampness, rot and infestation	
Repair category	1
Notes	<p>Hampton Timber Specialists (Dundee) Ltd carried out an inspection of the subjects on the 17th July 2024 and have recently completed treatment works and re plastering the party wall in the rear bedroom. Guarantee documentation should be obtained and checked.</p> <p>Damp meter readings were taken where considered appropriate within the property and moisture levels were found to be within an acceptable range.</p>

 Chimney stacks	
Repair category	2
Notes	There is weathering and defective pointing to the stonework on the chimney heads and vegetation at the chimney heads and copings. Mutual maintenance repairs are required.

Single Survey



Roofing including roof space

Repair category	2
Notes	<p>Fairmuir Roofing carried out repairs in July 2024 to renew the cement skews and replace missing slates. A copy of the relevant documentation should be obtained and checked.</p> <p>From ground level no view was possible of the slaterwork/roof coverings although where seen there is a slipped slate within the gutter. Roof coverings are assumed to be the original and are of an age and style where a degree of regular ongoing maintenance should be anticipated. More extensive overhaul work may be required in the future and further advice should be obtained from a firm of roofing contractors to fully ascertain the condition and life expectancy of the covering.</p>



Rainwater fittings

Repair category	2
Notes	Vegetation growth is affecting the front gutter/downpipe. Maintenance is required and gutters/downpipes should be checked during heavy rainfall.



Main walls

Repair category	2
Notes	There is evidence of general scaling, weathering and erosion to the stonework, particularly evident on the front elevation and areas of cracked and bossed rendering at the window bands.



Windows, external doors and joinery

Repair category	2
Notes	Windows were not all fully opened or tested and it will be appreciated that some defects are only evident during certain weather conditions. Windows are of mixed styles with some units being of an age where a degree of ongoing maintenance should be anticipated to sealed units and opening mechanisms. It would appear that the rear bedroom unit has failed having allowed condensation to form between the panes and some units were noted to be stiff in operation. Maintenance repairs are required.



External decorations

Repair category	N/A
Notes	Not applicable.

Single Survey



Conservatories/porches

Repair category	N/A
Notes	Not applicable.



Communal areas

Repair category	2
Notes	<p>There is graffiti affecting the mutual close at the entrance door, plaster cracking within the stairwell and sash and case windows are weathered and will deteriorate if left unattended.</p> <p>Textured coatings were noted to the walls and ceilings within the mutual stairwell. On rare occasions, these materials can have an asbestos content. We have not tested these materials nor carried out an asbestos survey however, until the material is professionally tested the linings should be left undisturbed and the material handled by a competent contractor only.</p>



Garages and permanent outbuildings

Repair category	1
Notes	Outbuildings are in fair condition having regard to their age and use.



Outside areas and boundaries

Repair category	1
Notes	Boundary walls and fences should be regularly checked and maintained as necessary.



Ceilings

Repair category	1
Notes	<p>Textured coatings were noted to the lounge ceiling. On rare occasions, these materials can have an asbestos content. We have not tested these materials nor carried out an asbestos survey however, until the material is professionally tested the linings should be left undisturbed and the material handled by a competent contractor only.</p> <p>Some cracked/uneven ceiling plaster was noted and some repairs may be required at the time of redecoration or disturbance.</p>

Single Survey



Internal walls

Repair category	1
Notes	Cracked/bossed wall plaster was noted and repairs may be required at the time of disturbance or redecoration.



Floors including sub-floors

Repair category	1
Notes	<p>Due to fitted carpets and floor coverings no detailed inspection of floors was possible and accordingly no comment can be made on their condition.</p> <p>There is an internal run in the flooring with some loose floorboards, not uncommon in a property of this age.</p>



Internal joinery and kitchen fittings

Repair category	1
Notes	Internal joinery is generally serviceable with some wear and tear noted to be affecting the kitchen fitments and the kitchen and shower room doors require joinery adjustment.



Chimney breasts and fireplaces

Repair category	2
Notes	The gas fire in the lounge is on dated lines and should be checked by a gas safe registered contractor.



Internal decorations

Repair category	1
Notes	The internal decoration will require to be upgraded dependant on individual taste.



Cellars

Repair category	N/A
Notes	Not applicable.

Single Survey



Electricity

Repair category	2
Notes	<p>Aspects of the electrical installation are on mixed/dated lines and there are a limited number of 13 amp sockets in some apartments by modern requirements. The system should be checked by a registered electrician and upgraded as necessary.</p> <p>The Institution of Engineering Technology recommends that inspections and testings are undertaken at least every five years and on a change of occupancy. It should be appreciated that only the most recently constructed or re-wired properties will have installations which fully comply with IET regulations.</p> <p>At the time of inspection the electricity supply was off.</p>



Gas

Repair category	1
Notes	<p>In the interests of safety and in light of recent regulations it would be prudent to have all gas appliances checked by a Gas Safe registered contractor.</p>



Water, plumbing and bathroom fittings

Repair category	1
Notes	<p>Sanitary fittings appear serviceable however surround seals, tiling and finishes should be checked and maintained watertight. We were unable to view concealed areas below sanitary fittings and cannot confirm they are free from damp or other defects.</p>



Heating and hot water

Repair category	1
Notes	<p>It is assumed that the central heating system has been properly installed, updated and maintained to meet with all current regulations and standards with particular regard to fluing and ventilation requirements. Service records should be obtained and checked. In the absence of service documentation further advice should be obtained from a qualified heating engineer to ascertain the condition, efficiency, and life expectancy of the system.</p> <p>Radiators are of a semi-modern vintage.</p>

Single Survey



Drainage

Repair category	1
Notes	All foul and surface water drainage is assumed to be to the main public sewer. The system was not tested.

Single Survey

Set out below is a summary of the condition of the property which is provided for reference only. You should refer to the previous comments for detailed information.

Structural movement	1
Dampness, rot and infestation	1
Chimney stacks	2
Roofing including roof space	2
Rainwater fittings	2
Main walls	2
Windows, external doors and joinery	2
External decorations	N/A
Conservatories/porches	N/A
Communal areas	2
Garages and permanent outbuildings	1
Outside areas and boundaries	1
Ceilings	1
Internal walls	1
Floors including sub-floors	1
Internal joinery and kitchen fittings	1
Chimney breasts and fireplaces	2
Internal decorations	1
Cellars	N/A
Electricity	2
Gas	1
Water, plumbing and bathroom fittings	1
Heating and hot water	1
Drainage	1

Category 3

Urgent repairs or replacement are needed now. Failure to deal with them may cause problems to other parts of the property or cause a safety hazard. Estimates for repairs or replacement are needed now.

Category 2

Repairs or replacement requiring future attention, but estimates are still advised.

Category 1

No immediate action or repair is needed.

Remember

The cost of repairs may influence the amount someone is prepared to pay for the property. We recommend that relevant estimates and reports are obtained in your own name.

Warning

If left unattended, even for a relatively short period, Category 2 repairs can rapidly develop into more serious Category 3 repairs. The existence of Category 2 or Category 3 repairs may have an adverse effect on marketability, value and the sale price ultimately achieved for the property. This is particularly true during slow market conditions where the effect can be considerable.

3. Accessibility information

Guidance notes on accessibility information

Three steps or fewer to a main entrance door of the property:

In flatted developments the 'main entrance' would be the flat's own entrance door, not the external door to the communal stair. The 'three steps or fewer' are counted from external ground level to the flat's entrance door. Where a lift is present, the count is based on the number of steps climbed when using the lift.

Unrestricted parking within 25 metres:

For this purpose, 'Unrestricted parking' includes parking available by means of a parking permit. Restricted parking includes parking that is subject to parking restrictions, as indicated by the presence of solid yellow, red or white lines at the edge of the road or by a parking control sign, parking meters or other coin-operated machines.

1. Which floor(s) is the living accommodation on?	Third			
2. Are there three steps or fewer to a main entrance door of the property?	Yes	<input type="checkbox"/>	No	<input checked="" type="checkbox"/>
3. Is there a lift to the main entrance door of the property?	Yes	<input type="checkbox"/>	No	<input checked="" type="checkbox"/>
4. Are all door openings greater than 750mm?	Yes	<input type="checkbox"/>	No	<input checked="" type="checkbox"/>
5. Is there a toilet on the same level as the living room and kitchen?	Yes	<input checked="" type="checkbox"/>	No	<input type="checkbox"/>
6. Is there a toilet on the same level as a bedroom?	Yes	<input checked="" type="checkbox"/>	No	<input type="checkbox"/>
7. Are all rooms on the same level with no internal steps or stairs?	Yes	<input checked="" type="checkbox"/>	No	<input type="checkbox"/>
8. Is there unrestricted parking within 25 metres of an entrance door to the building?	Yes	<input checked="" type="checkbox"/>	No	<input type="checkbox"/>

4. Valuation and conveyancer issues

This section highlights information that should be checked with a solicitor or licensed conveyancer. It also gives an opinion of market value and an estimated reinstatement cost for insurance purposes.

Matters for a solicitor or licensed conveyancer

The subjects form part of a tenement block of flats and it has been assumed that maintenance/repair costs of the common parts of the building will be shared on an equitable basis with adjoining proprietors. It is therefore assumed that the cost of common repairs detailed within the report will be apportioned accordingly although exact liability should be confirmed.

Where defects or repairs have been identified within this report it is recommended that, prior to entering into any legally binding sale or purchase contract, further specialist's or contractor's advice and estimates should be obtained, to establish the implications, if any, on a potential offer to purchase or the sale price likely to be achieved for the property.

Damp specialist treatment works have been carried out within the property and it is assumed that all specialist reports and guarantees are available and in order. Confirmation should be obtained.

It is assumed that there are no statutory, town planning, road proposals or environmental matters which are likely to have an adverse effect on the property.

The road and footpath adjoining the site are made up and are assumed to be adopted by the Local Authority.

This is a Replacement Home Report, our original inspection was carried out on 08/07/2024.

Estimated reinstatement cost for insurance purposes

For Reinstatement Cost Assessment purposes, it is recommended that the subjects be insured for a sum of not less than £245,000 (TWO HUNDRED AND FORTY-FIVE THOUSAND POUNDS)..

This figure is the estimate of the cost of rebuilding the premises and bears no direct relationship to current market value.

Valuation and market comments

Having considered matters, taking account of our general observations on site, we are of the opinion that the Market Value of the subjects in their present condition and with the benefit of vacant possession may be fairly stated in the sum of £70,000 (SEVENTY THOUSAND POUNDS).

Signed

Paul Taylor
Electronically signed :- 18/03/2025 16:03

Single Survey

Report author	Paul Taylor
Company name	J & E Shepherd Chartered Surveyors
Address	13 Albert Square Meadowside Dundee DD1 1XA
Date of report	17/03/2025

Mortgage Valuation Report



Property Address

Address 362g Strathmore Avenue, Dundee, DD3 6RU
Seller's Name Peter & Anne Turrell
Date of Inspection 17/03/2025

Property Details

Property Type ☐ House ☐ Bungalow ☐ Purpose built maisonette ☐ Converted maisonette
☐ Purpose built flat ☐ Converted flat ☒ Tenement flat ☐ Flat over non-residential use
☐ Other (specify in General Remarks)

Property Style ☐ Detached ☐ Semi detached ☒ Mid terrace ☐ End terrace
☐ Back to back ☐ High rise block ☐ Low rise block ☐ Other (specify in General Remarks)

Does the surveyor believe that the property was built for the public sector, e. g. local authority, military, police? ☐ Yes ☒ No

Flats/Maisonettes only Floor(s) on which located No. of floors in block Lift provided? ☐ Yes ☒ No
No. of units in block

Approximate Year of Construction

Tenure

☒ Absolute Ownership ☐ Other

Accommodation

Number of Rooms Living room(s) Bedroom(s) Kitchen(s)
 Bathroom(s) WC(s) Other (Specify in General remarks)

Gross Floor Area (excluding garages and outbuildings) m² (Internal) m² (External)
Residential Element (greater than 40%) ☒ Yes ☐ No

Garage / Parking / Outbuildings

☐ Single garage ☐ Double garage ☐ Parking space ☒ No garage / garage space / parking space
Available on site? ☐ Yes ☒ No

Permanent outbuildings:

Mortgage Valuation Report

Construction

Walls ☐ Brick ☒ Stone ☐ Concrete ☐ Timber frame ☐ Other (specify in General Remarks)
Roof ☐ Tile ☒ Slate ☐ Asphalt ☐ Felt ☐ Other (specify in General Remarks)

Special Risks

Has the property suffered structural movement? ☒ Yes ☐ No

If Yes, is this recent or progressive? ☐ Yes ☒ No

Is there evidence, history, or reason to anticipate subsidence, heave, landslip or flood in the immediate vicinity? ☐ Yes ☒ No

If Yes to any of the above, provide details in General Remarks.

Service Connections

Based on visual inspection only. If any services appear to be non-mains, please comment on the type and location of the supply in General Remarks

Drainage ☒ Mains ☐ Private ☐ None Water ☒ Mains ☐ Private ☐ None
Electricity ☒ Mains ☐ Private ☐ None Gas ☒ Mains ☐ Private ☐ None
Central Heating ☒ Yes ☐ Partial ☐ None

Brief description of Central Heating and any non mains services:

Gas fired combination boiler to radiators.

Site

Apparent legal issues to be verified by the conveyancer. Please provide a brief description in General Remarks.

☐ Rights of way ☒ Shared drives / access ☐ Garage or other amenities on separate site ☐ Shared service connections
☐ Ill-defined boundaries ☐ Agricultural land included with property ☐ Other (specify in General Remarks)

Location

☐ Residential suburb ☐ Residential within town / city ☒ Mixed residential / commercial ☐ Shared service connections
☐ Commuter village ☐ Remote village ☐ Isolated rural property ☐ Other (specify in General Remarks)

Planning Issues

Has the property been extended / converted / altered? ☐ Yes ☒ No

If Yes provide details in General Remarks.

Roads

☐ Made up road ☐ Unmade road ☐ Partly completed new road ☐ Pedestrian access only ☒ Adopted ☐ Unadopted

Mortgage Valuation Report

General Remarks

The subjects comprise a purpose built third floor flat forming part of a four storey mid terraced tenement situated in a mixed location one and a half miles north of Dundee City centre. Adequate public transport, shopping, social and educational facilities are available within easy reach.

At the time of inspection the property was found to be in a condition generally consistent with its age and type of construction but some works of maintenance and repair are required. Elements of the property are aging and likely to require attention.

The subjects form part of a tenement block of flats and it has been assumed that maintenance/repair costs of the common parts of the building will be shared on an equitable basis with adjoining proprietors. It is therefore assumed that the cost of common repairs detailed within the report will be apportioned accordingly although exact liability should be confirmed.

Essential Repairs

None.

Estimated cost of essential repairs

Retention recommended? ☐ Yes ☒ No

Retention amount

Comment on Mortgageability

The property forms suitable security for mortgage purposes subject to the specific lending criteria of any mortgage provider.

Valuation

Market value in present condition £

Market value on completion of essential repairs £

Insurance reinstatement value £

(to include the cost of total rebuilding, site clearance, professional fees, ancillary charges plus VAT)

Is a reinspection necessary? ☐ Yes ☒ No

Mortgage Valuation Report

Declaration

Signed	<i>Paul Taylor</i> Electronically signed :- 18/03/2025 16:03
Surveyor's name	Paul Taylor
Professional qualifications	MRICS
Company name	J & E Shepherd Chartered Surveyors
Address	13 Albert Square, Meadowside, Dundee, DD1 1XA
Telephone	01382 200454
Email Address	dundeeresidential@shepherd.co.uk
Date of Inspection	17/03/2025



Energy Performance Certificate



Energy Performance Certificate (EPC)

Scotland

Dwellings

362G STRATHMORE AVENUE, DUNDEE, DD3 6RU

Dwelling type: Top-floor flat
Date of assessment: 17 March 2025
Date of certificate: 17 March 2025
Total floor area: 54 m²
Primary Energy Indicator: 226 kWh/m²/year

Reference number: 0140-2463-3170-2695-4315
Type of assessment: RdSAP, existing dwelling
Approved Organisation: Elmhurst
Main heating and fuel: Boiler and radiators, mains gas

You can use this document to:

- Compare current ratings of properties to see which are more energy efficient and environmentally friendly
- Find out how to save energy and money and also reduce CO₂ emissions by improving your home

Estimated energy costs for your home for 3 years*	£2,241	See your recommendations report for more information
Over 3 years you could save*	£441	

* based upon the cost of energy for heating, hot water, lighting and ventilation, calculated using standard assumptions

Very energy efficient - lower running costs



Not energy efficient - higher running costs

Current	Potential
73	78

Energy Efficiency Rating

This graph shows the current efficiency of your home, taking into account both energy efficiency and fuel costs. The higher this rating, the lower your fuel bills are likely to be.

Your current rating is **band C (73)**. The average rating for EPCs in Scotland is **band D (61)**.

The potential rating shows the effect of undertaking all of the improvement measures listed within your recommendations report.

Very environmentally friendly - lower CO₂ emissions



Not environmentally friendly - higher CO₂ emissions

Current	Potential
74	81

Environmental Impact (CO₂) Rating

This graph shows the effect of your home on the environment in terms of carbon dioxide (CO₂) emissions. The higher the rating, the less impact it has on the environment.

Your current rating is **band C (74)**. The average rating for EPCs in Scotland is **band D (59)**.

The potential rating shows the effect of undertaking all of the improvement measures listed within your recommendations report.

Top actions you can take to save money and make your home more efficient

Recommended measures	Indicative cost	Typical savings over 3 years
1 Internal or external wall insulation	£4,000 - £14,000	£378.00
2 Low energy lighting	£10	£63.00

A full list of recommended improvement measures for your home, together with more information on potential cost and savings and advice to help you carry out improvements can be found in your recommendations report.

To find out more about the recommended measures and other actions you could take today to stop wasting energy and money, visit greenerscotland.org or contact Home Energy Scotland on 0808 808 2282.

THIS PAGE IS THE ENERGY PERFORMANCE CERTIFICATE WHICH MUST BE AFFIXED TO THE DWELLING AND NOT BE REMOVED UNLESS IT IS REPLACED WITH AN UPDATED CERTIFICATE

Summary of the energy performance related features of this home

This table sets out the results of the survey which lists the current energy-related features of this home. Each element is assessed by the national calculation methodology; 1 star = very poor (least efficient), 2 stars = poor, 3 stars = average, 4 stars = good and 5 stars = very good (most efficient). The assessment does not take into consideration the condition of an element and how well it is working. 'Assumed' means that the insulation could not be inspected and an assumption has been made in the methodology, based on age and type of construction.

Element	Description	Energy Efficiency	Environmental
Walls	Sandstone or limestone, as built, no insulation (assumed)	★★☆☆☆	★★☆☆☆
	Solid brick, as built, partial insulation (assumed)	★★★☆☆	★★★☆☆
Roof	Pitched, 150 mm loft insulation	★★★★☆	★★★★☆
Floor	(another dwelling below)	—	—
Windows	Fully double glazed	★★★★☆☆	★★★★☆☆
Main heating	Boiler and radiators, mains gas	★★★★☆	★★★★☆
Main heating controls	Programmer, TRVs and bypass	★★★★☆☆	★★★★☆☆
Secondary heating	Room heaters, mains gas	—	—
Hot water	From main system	★★★★☆	★★★★☆
Lighting	Low energy lighting in 60% of fixed outlets	★★★★☆	★★★★☆

The energy efficiency rating of your home

Your Energy Efficiency Rating is calculated using the standard UK methodology, RdSAP. This calculates energy used for heating, hot water, lighting and ventilation and then applies fuel costs to that energy use to give an overall rating for your home. The rating is given on a scale of 1 to 100. Other than the cost of fuel for electrical appliances and for cooking, a building with a rating of 100 would cost almost nothing to run.

As we all use our homes in different ways, the energy rating is calculated using standard occupancy assumptions which may be different from the way you use it. The rating also uses national weather information to allow comparison between buildings in different parts of Scotland. However, to make information more relevant to your home, local weather data is used to calculate your energy use, CO₂ emissions, running costs and the savings possible from making improvements.

The impact of your home on the environment

One of the biggest contributors to global warming is carbon dioxide. The energy we use for heating, lighting and power in our homes produces over a quarter of the UK's carbon dioxide emissions. Different fuels produce different amounts of carbon dioxide for every kilowatt hour (kWh) of energy used. The Environmental Impact Rating of your home is calculated by applying these 'carbon factors' for the fuels you use to your overall energy use.

The calculated emissions for your home are 40 kg CO₂/m²/yr.

The average Scottish household produces about 6 tonnes of carbon dioxide every year. Based on this assessment, heating and lighting this home currently produces approximately 2.2 tonnes of carbon dioxide every year. Adopting recommendations in this report can reduce emissions and protect the environment. If you were to install all of these recommendations this could reduce emissions by 0.5 tonnes per year. You could reduce emissions even more by switching to renewable energy sources.



Estimated energy costs for this home

	Current energy costs	Potential energy costs	Potential future savings
Heating	£1,659 over 3 years	£1,290 over 3 years	
Hot water	£324 over 3 years	£324 over 3 years	
Lighting	£258 over 3 years	£186 over 3 years	
Totals	£2,241	£1,800	

These figures show how much the average household would spend in this property for heating, lighting and hot water. This excludes energy use for running appliances such as TVs, computers and cookers, and the benefits of any electricity generated by this home (for example, from photovoltaic panels). The potential savings in energy costs show the effect of undertaking all of the recommended measures listed below.

Recommendations for improvement

The measures below will improve the energy and environmental performance of this dwelling. The performance ratings after improvements listed below are cumulative; that is, they assume the improvements have been installed in the order that they appear in the table. Further information about the recommended measures and other simple actions to take today to save money is available from the Home Energy Scotland hotline which can be contacted on 0808 808 2282. Before carrying out work, make sure that the appropriate permissions are obtained, where necessary. This may include permission from a landlord (if you are a tenant) or the need to get a Building Warrant for certain types of work.

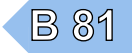
Recommended measures	Indicative cost	Typical saving per year	Rating after improvement	
			Energy	Environment
1 Internal or external wall insulation	£4,000 - £14,000	£126		
2 Low energy lighting for all fixed outlets	£10	£21		

Choosing the right improvement package

For free and impartial advice on choosing suitable measures for your property, contact the Home Energy Scotland hotline on 0808 808 2282 or go to www.greenerscotland.org.

About the recommended measures to improve your home's performance rating

This section offers additional information and advice on the recommended improvement measures for your home

1 Internal or external wall insulation

Internal or external wall insulation involves adding a layer of insulation to either the inside or the outside surface of the external walls, which reduces heat loss and lowers fuel bills. As it is more expensive than cavity wall insulation it is only recommended for walls without a cavity, or where for technical reasons a cavity cannot be filled. Internal insulation, known as dry-lining, is where a layer of insulation is fixed to the inside surface of external walls; this type of insulation is best applied when rooms require redecorating. External solid wall insulation is the application of an insulant and a weather-protective finish to the outside of the wall. This may improve the look of the home, particularly where existing brickwork or rendering is poor, and will provide long-lasting weather protection. Further information can be obtained from the National Insulation Association (www.nationalinsulationassociation.org.uk). It should be noted that a building warrant is required for the installation of external wall insulation. Planning permission may also be required and that building regulations apply to external insulation so it is best to check with your local authority on both issues.

2 Low energy lighting

Replacement of traditional light bulbs with energy saving bulbs will reduce lighting costs over the lifetime of the bulb, and they last many times longer than ordinary light bulbs. Low energy lamps and fittings are now commonplace and readily available. Information on energy efficiency lighting can be found from a wide range of organisations, including the Energy Saving Trust (<http://www.energysavingtrust.org.uk/home-energy-efficiency/lighting>).

Low and zero carbon energy sources

Low and zero carbon (LZC) energy sources are sources of energy that release either very little or no carbon dioxide into the atmosphere when they are used. Installing these sources may help reduce energy bills as well as cutting carbon.

LZC energy sources present: There are none provided for this home

Your home's heat demand

In this section, you can see how much energy you might need to heat your home and provide hot water. These are estimates showing how an average household uses energy. These estimates may not reflect your actual energy use, which could be higher or lower. You might spend more money on heating and hot water if your house is less energy efficient. The table below shows the potential benefit of having your loft and walls insulated. Visit <https://energysavingtrust.org.uk/energy-at-home> for more information.

Heat demand	Existing dwelling	Impact of loft insulation	Impact of cavity wall insulation	Impact of solid wall insulation
Space heating (kWh per year)	5,664	(433)	N/A	(1,866)
Water heating (kWh per year)	1,660			

Addendum

This dwelling has stone walls and so requires further investigation to establish whether these walls are of cavity construction and to determine which type of wall insulation is best suited.

About this document

This Recommendations Report and the accompanying Energy Performance Certificate are valid for a maximum of ten years. These documents cease to be valid where superseded by a more recent assessment of the same building carried out by a member of an Approved Organisation.

The Energy Performance Certificate and this Recommendations Report for this building were produced following an energy assessment undertaken by an assessor accredited by Elmhurst (www.elmhurstenergy.co.uk), an Approved Organisation Appointed by Scottish Ministers. The certificate has been produced under the Energy Performance of Buildings (Scotland) Regulations 2008 from data lodged to the Scottish EPC register. You can verify the validity of this document by visiting www.scottishepcregister.org.uk and entering the report reference number (RRN) printed at the top of this page.

Assessor's name:	Mr. Paul Taylor
Assessor membership number:	EES/012881
Company name/trading name:	J & E Shepherd
Address:	13 Albert Square Dundee DD1 1XA
Phone number:	01382 200454
Email address:	dundee@shepherd.co.uk
Related party disclosure:	No related party

If you have any concerns regarding the content of this report or the service provided by your assessor you should in the first instance raise these matters with your assessor and with the Approved Organisation to which they belong. All Approved Organisations are required to publish their complaints and disciplinary procedures and details can be found online at the web address given above.

Use of this energy performance information

Once lodged by your EPC assessor, this Energy Performance Certificate and Recommendations Report are available to view online at www.scottishepcregister.org.uk, with the facility to search for any single record by entering the property address. This gives everyone access to any current, valid EPC except where a property has a Green Deal Plan, in which case the report reference number (RRN) must first be provided. The energy performance data in these documents, together with other building information gathered during the assessment is held on the Scottish EPC Register and is available to authorised recipients, including organisations delivering energy efficiency and carbon reduction initiatives on behalf of the Scottish and UK governments. A range of data from all assessments undertaken in Scotland is also published periodically by the Scottish Government. Further information on these matters and on Energy Performance Certificates in general, can be found at www.gov.scot/epc.

Advice and support to improve this property

There is support available, which could help you carry out some of the improvements recommended for this property on page 3 and stop wasting energy and money. For more information, visit [greener-scotland.org](https://www.greener-scotland.org) or contact Home Energy Scotland on 0808 808 2282.

Home Energy Scotland's independent and expert advisors can offer free and impartial advice on all aspects of energy efficiency, renewable energy and more.

HOMEENERGYSCOTLAND.ORG
0808 808 2282
FUNDED BY THE SCOTTISH GOVERNMENT





Property Questionnaire



property questionnaire

Property address	362g Strathmore Avenue Dundee DD3 6RU
Seller(s)	Peter & Anne Turrell
Completion date of property questionnaire	23/05/2024

property questionnaire

Note for sellers

- Please complete this form carefully. It is important that your answers are correct.
- The information in your answers will help ensure that the sale of your house goes smoothly. Please answer each question with as much detailed information as you can.
- If anything changes after you fill in this questionnaire but before the date of entry for the sale of your house, tell your solicitor or estate agent immediately.

Information to be given to prospective buyer(s)

1.	Length of ownership	
	How long have you owned the property?	7 years
2.	Council tax	
	Which Council Tax band is your property in?	B
3.	Parking	
	<p>What are the arrangements for parking at your property? (Please tick all that apply)</p> <ul style="list-style-type: none">• Garage <input type="text" value="No"/>• Allocated parking space <input type="text" value="No"/>• Driveway <input type="text" value="No"/>• Shared parking <input type="text" value="No"/>• On street <input type="text" value="Yes"/>• Resident permit <input type="text" value="No"/>• Metered Parking <input type="text" value="No"/>• Other (please specify): <input type="text"/>	
4.	Conservation area	
	Is your property in a designated Conservation Area (that is an area of special architectural or historical interest, the character or appearance of which it is desirable to preserve or enhance)?	Don't know

property questionnaire

5.	Listed buildings	
	Is your property a Listed Building, or contained within one (that is a building recognised and approved as being of special architectural or historical interest)?	No
6.	Alterations/additions/extensions	
a.	<p>(i) During your time in the property, have you carried out any structural alterations, additions or extensions (for example, provision of an extra bath/shower room, toilet, or bedroom)?</p> <p><u>If you have answered yes</u>, please describe below the changes which you have made:</p>	No
	<p>(ii) Did you obtain planning permission, building warrant, completion certificate and other consents for this work?</p> <p><u>If you have answered yes</u>, the relevant documents will be needed by the purchaser and you should give them to your solicitor as soon as possible for checking.</p> <p>If you do not have the documents yourself, please note below who has these documents and your solicitor or estate agent will arrange to obtain them:</p>	
b.	<p>Have you had replacement windows, doors, patio doors or double glazing installed in your property?</p> <p><u>If you have answered yes</u>, please answer the three questions below:</p>	No
	(i) Were the replacements the same shape and type as the ones you replaced?	
	(ii) Did this work involve any changes to the window or door openings?	
	<p>(iii) Please describe the changes made to the windows doors, or patio doors (with approximate dates when the work was completed):</p> <p>Please give any guarantees which you received for this work to your solicitor or estate agent.</p>	
7.	Central heating	
a.	<p>Is there a central heating system in your property? (Note: a partial central heating system is one which does not heat all the main rooms of the property — the main living room, the bedroom(s), the hall and the bathroom).</p> <p><u>If you have answered yes or partial</u> – what kind of central heating is there? (Examples: gas-fired, solid fuel, electric storage heating, gas warm air).</p>	No

property questionnaire

	If you have answered <u>yes</u>, please answer the three questions below:		
	i) When was your central heating system or partial central heating system installed?		
	(ii) Do you have a maintenance contract for the central heating system? <u>If you have answered yes</u>, please give details of the company with which you have a maintenance contract:		
	(iii) When was your maintenance agreement last renewed? (Please provide the month and year).		
8.	Energy Performance Certificate		
	Does your property have an Energy Performance Certificate which is less than 10 years old?		Yes
9.	Issues that may have affected your property		
a.	Has there been any storm, flood, fire or other structural damage to the property while you have owned it? <u>If you have answered yes</u>, is the damage the subject of any outstanding insurance claim?		Yes No
b.	Are you aware of the existence of asbestos in your property? <u>If you have answered yes</u>, please give details:		No
10.	Services		
a.	Please tick which services are connected to your property and give details of the supplier:		
	Services	Connected	Supplier
	Gas or liquid petroleum gas	No	
	Water mains or private water supply	Yes	Scottish Water
	Electricity	Yes	OVO Energy
	Mains drainage	Yes	Local Authority
	Telephone	No	
	Cable TV or satellite	No	

property questionnaire

	Broadband	No	
b.	Is there a septic tank system at your property?		No
	<u>If you have answered yes</u> , please answer the two questions below:		
	(i) Do you have appropriate consents for the discharge from your septic tank?		
	(ii) Do you have a maintenance contract for your septic tank?		
	<u>If have answered yes</u> , details of the company with which you have a maintenance contract:		
11.	Responsibilities for shared or common areas		
a.	Are you aware of any responsibility to contribute to the cost of anything used jointly, such as the repair of a shared drive, private road, boundary, or garden area?		Don't know
	<u>If you have answered yes</u> , please give details:		
b.	Is there a responsibility to contribute to repair and maintenance of the roof, common stairwell or other common areas?		Yes
	<u>If you have answered yes</u> , please give details:		
	Currently roof being repaired		
c.	Has there been any major repair or replacement of any part of the roof during the time you have owned the property?		Yes
d.	Do you have the right to walk over any of your neighbours' property — for example to put out your rubbish bin or to maintain your boundaries?		No
	<u>If you have answered yes</u> , please give details:		
e.	As far as you are aware, do any of your neighbours have the right to walk over your property, for example to put out their rubbish bin or to maintain their boundaries?		No
	<u>If you have answered yes</u> , please give details:		
f.	As far as you are aware, is there a public right of way across any part of your property? (public right of way is a way over which the public has a right to pass, whether or not the land is privately-owned.)		No
	<u>If you have answered yes</u> , please give details:		
12.	Charges associated with the property		

property questionnaire

a.	<p>Is there a factor or property manager for your property?</p> <p><u>If you have answered yes</u>, please provide the name and address, and give details of any deposit held and approximate charges:</p> <p>Premier Property but will cease as tennant has moved out</p>	Yes
b.	<p>Is there a common buildings insurance policy?</p> <p><u>If you have answered yes</u>, is the cost of the insurance included in monthly/annual factor's charges?</p>	Don't know
c.	Please give details of any other charges you have to pay on a regular basis for the upkeep of common areas or repair works, for example to a residents' association, or maintenance or stair fund.	
13.	Specialist work	
a.	<p>As far as you are aware, has treatment of dry rot, wet rot, damp or any other specialist work ever been carried out to your property?</p> <p><u>If you have answered yes</u>, please say what the repairs were for, whether you carried out the repairs (and when) or if they were done before you bought the property.</p>	No
b.	<p>As far as you are aware, has any preventative work for dry rot, wet rot, or damp ever been carried out to your property?</p> <p><u>If you have answered yes</u>, please give details:</p>	No
c.	<p><u>If you have answered yes</u> to 13(a) or (b), do you have any guarantees relating to this work?</p> <p><u>If you have answered yes</u>, these guarantees will be needed by the purchaser and should be given to your solicitor as soon as possible for checking. If you do not have them yourself <u>please write below who has these documents</u> and your solicitor or estate agent will arrange for them to be obtained. You will also need to provide a description of the work carried out. This may be shown in the original estimate.</p> <p>Guarantees are held by:</p>	
14.	Guarantees	
a.	Are there any guarantees or warranties for any of the following?	
	(i) Electrical work	Don't know
	(ii) Roofing	Don't know
	(iii) Central heating	Don't know

property questionnaire

	(iv) National House Building Council (NHBC)	Don't know
	(v) Damp course	Don't know
	(vi) Any other work installations? (for example, cavity wall installation, underpinning, indemnity policy)	Don't know
b.	<u>If you have answered 'yes' or 'with title deeds', please give details of the work or installations to which the guarantee(s) relate(s):</u>	
c.	Are there any outstanding claims under any of the guarantees listed above?<u>If you have answered yes</u>, please give details:	No
15.	Boundaries	
	So far as you are aware, has any boundary of your property been moved in the last 10 years? <u>If you have answered yes</u>, please give details:	No
16.	Notices that affect your property	
	In the past three years have you ever received a notice:	
a.	advising that the owner of a neighbouring property has made a planning application?	No
b.	that affects your property in some other way?	No
c.	that requires you to do any maintenance, repairs or improvements to your property?	No
	<u>If you have answered yes to any of a–c above</u>, please give the notices to your solicitor or estate agent, including any notices which arrive at any time before the date of entry of the purchaser of your property.	

Declaration by the seller(s)/or other authorised body or person(s)

I/We confirm that the information in this form is true and correct to the best of my/our knowledge and belief

Name(s): Anne Turrell

Date: 23/05/2024



Appendices



Inspection Report



18th July 2024

Clients Name: Mr Ian Davidson

Client Address: Martin & Co, Unit 18 City Quay, Camperdown Street, Dundee, DD1 3JA

Property Address: 362G Strathmore Avenue, Dundee, DD3 6RU

Email Address: ian.davidson@martinco.com

Inspection Date: 17th July 2024

Dear Mr Davidson

Thank you for inviting us to report on this property, the inspection of which was carried out by our surveyor Sandy Watson on 17th July 2024. In accordance with your instructions, we have confined our inspection to the under mentioned accessible areas. If there are any omissions or, if you believe that we have misunderstood your instructions please let us know without delay.

Our report and recommendations are set out below and should be read in conjunction with the attached specification.

The terms Left, Right, Front and Rear are used as if one is standing outside the building facing the front elevation.

PROPERTY DESCRIPTION: TOP FLOOR RIGHT FLAT IN STONE BUILT BLOCK OF FLATS

Mutal Roof Void

No access could be made.

Flat

Floors

Restricted inspection due to fitted floor coverings. Where seen from various corners only, no apparent evidence.

No comment to kitchen or bathroom floors due to ceramic tiles and vinyl overlay.

High moisture readings were obtained to wall and ceiling in room rear right. In our opinion, this has been caused by water penetration due to defective roof coverings which we understand have now been repaired.

Our technicians will carry out the following works:

1. Lay floor protector to point of treatment.
2. Tape doors to minimise the spread of dust.
3. Carefully remove skirting.
4. Strip ceiling as indicated on attached sketch.

5. Strip wall as indicated on attached sketch.
6. Dwang ceiling to facilitate plasterboard.
7. Apply a fungicide fluid to exposed ceiling timbers as precaution only.
8. Fit vented membrane to exposed wall.
9. Plasterboard ceiling and apply a skimcoat of plaster.
10. Dot and dab membrane and apply a skimcoat of plaster.
11. Remove all debris to yard skip.
12. Refit skirtings.
13. Uplift roll and stroll and tape from doors.
14. Leave site tidy.

Please note that we feel it is important that there are various concealed timbers that cannot be inspected during a normal survey of a property such as timber safe lintels, bonding timbers, wall framing and lath, wall plugs, "built in" joist ends and wall plate etc which are hidden by wall linings. We therefore cannot comment on any of these or any other concealed timbers at this time.

We respectfully draw your attention to the fact that during this pre-purchase survey the inspection was limited due to fitted floor coverings etc therefore, the inspection was limited accordingly. We cannot be held responsible for any defect other than those mentioned in this report. Nor can we be held responsible for any structural defects found. This type of defect should be pointed out to yourself by your own Surveyor.

Whilst our technicians will remove all resulting debris and rubble from the site during our treatments, we cannot accept the responsibility of dust cleaning, vacuuming and general cleaning once our treatments have been completed. The site will be left reasonably clean and tidy, but a cleaning contractor should be employed by you for final cleaning operations.

During our inspection we carried out an assessment of potential hazards and health risks which might arise during the course of our works. These were done under the **COSHH (Control of Substances Hazardous to Health) Regulations 1989**. We noted that the property was unoccupied at the time of our inspection. We have assumed that it will be unoccupied when we carry out our works.

When you ask us to carry out these works, please let us know if there are any changes in this assumption or, if there are any other material changes when we start work. We can forward a copy of our assessment to you.

Timbers will be treated using WYKAMOL Micro Insecticide/Dual Purpose which has been given a one-hour re-entry classification by The Health & Safety Executive.

Plaster work and Builder work are covered by a one-year guarantee and not by our usual 10-year guarantee which covers timber treatments and damp proofing only.

We respectfully draw your attention to the fact that you will be required to provide an electric power supply during our works otherwise an extra charge will be made for the hire of a portable Generator. A supply of water is also required.

This Report is a Copyright and is for the addressee only. We can accept no responsibility for our Survey, or this Report towards any other person (s). On no account must it be duplicated or copied in whole or part without the Agreement of our Head Office.

As a business we deliver the following Services:

- **Woodworm Eradication**
- **Condensation Control**
- **Dry Rot Eradication**
- **Wet Rot Eradication**
- **Rising Damp Control**
- **Penetrating Damp Control**
- **Basement Tanking (Water Management Systems)**
- **Insurance Repair Work**
- **General Joinery Work**

YOUR SURVEYOR AND HOW TO CONTACT US

The Surveyor dealing with your property is Sandy Watson

He can be contacted on 01382 450555 or by email at enquiries@hamptons.scot

Please do not hesitate to contact this office for any further information you may require.

Yours faithfully

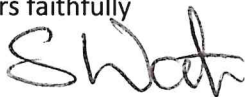

Mr Sandy Watson
Hampton Timber Specialists (Dundee) Ltd



HAMPTON

Timber Specialists (Dundee) Ltd

Mr Ian Davidson
Martin & Co.
33 Albert Square
Dundee
DD1 2PP

Quotation No 18/07/2024
Quotation Date 2746
Order No
Account Ref MARTINCO

Quantity	Description	Unit Price	Net Amt	VAT %	VAT
1.00	Re: 362G Strathmore Avenue, Dundee, DD3 6RU Builder work Plaster work as per our report dated 18th July 2024	1,792.00	1,792.00	20.00	358.40

Terms and Conditions Apply: I understand the observations and recommendations contained in the Report and confirm that they correspond with my instructions to request an estimate for remedial work as required in relation to the property. I fully understand and accept the Terms of the transferable 10 Year Guarantee which only applies in relation TO THE AREAS OF THE PROPERTY WHERE REMEDIAL WORK HAS BEEN IDENTIFIED IN THE REPORT.

I accept that the proposed remedial work does not include carpeting, the moving of furniture, removal of any fixtures and fittings, decoration, electrical or plumbing work UNLESS this has been specifically provided in the quotation.

Total Net Amount £ 1,792.00
VAT Amount £ 358.40
Invoice Total £ 2,150.40



Unit 11, Barlow Park, West Pitkerro Ind. Est., Broughty Ferry, Dundee, DD5 3UB
Tel: 01382 450555 enquiries@hamptons.scot
Directors: M J Hampton (CITS) B.P.C.D. H.A. inst R.T.S. & L A Hampton
Registered in Scotland. Company No: 473980 VAT Registration No: 187042109



KEY TO ITEMS TO BE REMOVED:-

AREA OF FLOOR/ROOF



WINDOWS



PLASTERWORK



VERTICAL BARRIER //

DOOR FRAME



LINTELS



DPC



HIGH GROUND LEVEL



HAMPTON TIMBER SPECIALISTS LTD

PROPERTY ADDRESS

TOP FLOOR RIGHT FLAT
362 G STRATHMORE
AVENUE DUNDEE

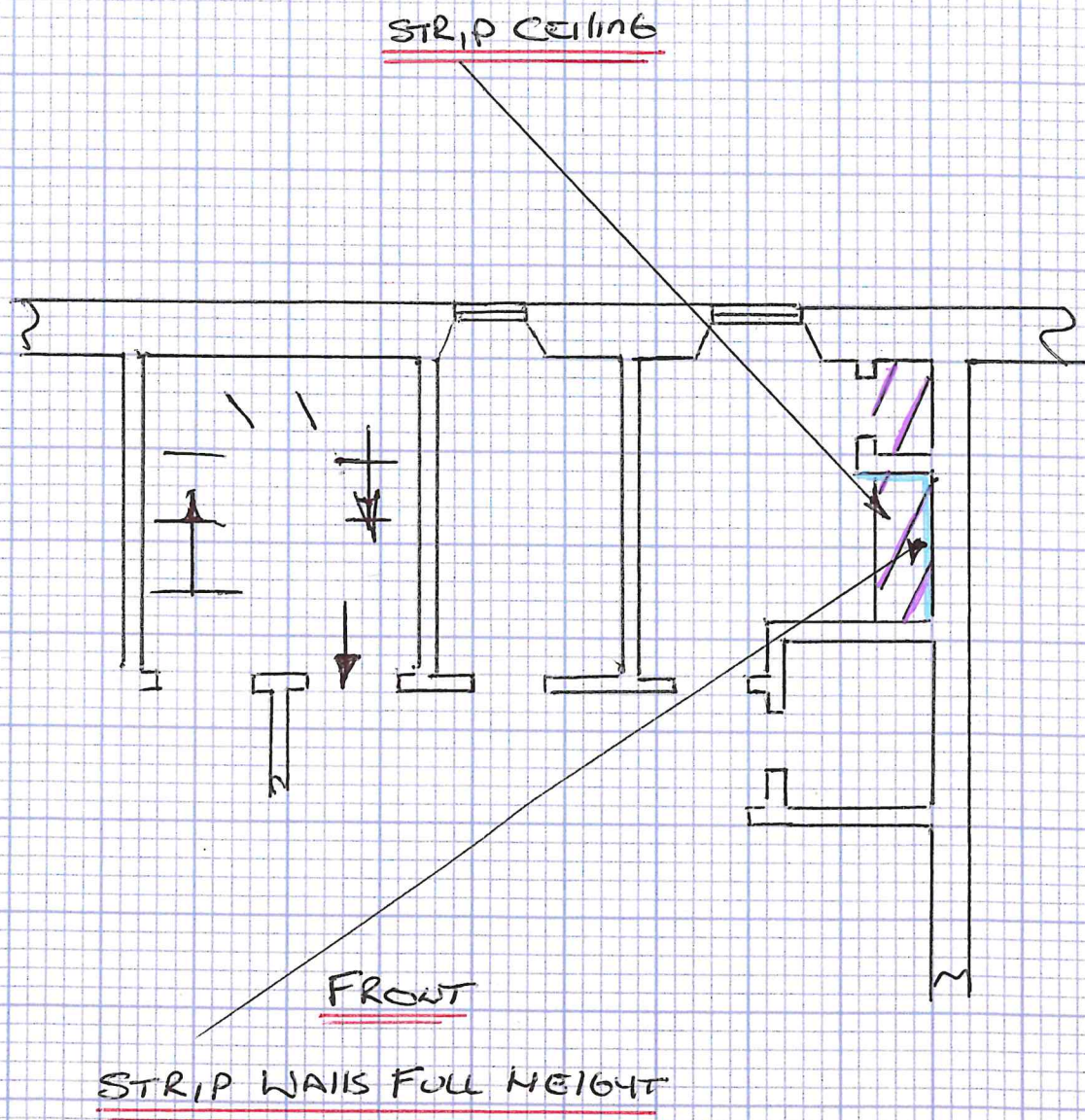



Home Report
Valuation Report
Executory Valuation
Tax Valuations
Separation Valuation
Private Sale Valuation
New Build & Plot Valuation
Insurance Reinstatement Valuation
Portfolio Valuation
Rental Valuation
Drive By & Desktop Valuation
Energy Performance Certificate (EPC)
Level Two Survey & Valuation Report
Level Two Condition Report
Expert Witness Report



Commercial Valuation
Commercial Agency
Acquisitions Consultancy
Commercial Lease Advisory
Rent Reviews
Asset Management
Development Appraisals & Consultancy
Auctions
Property Management
Professional Services
Licensed Trade & Leisure
Expert Witness Report
Rating
Property Investment
Public Sector



Quantity Surveying
Building Surveying
Project Management
Dispute Resolution Support Services
Principal Designer
Clerk of Works
Commercial EPC
Health & Safety Management
Employer's Agent
Energy Consultancy
Housing Partnerships
Housing Consultancy
Development Monitoring
Mediation Services

Aberdeen

△△△ 01224 202800

Ayr

△△ 01292 267987

Bearsden

△△ 0141 611 1500

Belfast

△ 02890 912975

Birmingham

△ 0121 270 2266

Coatbridge

△△ 01236 436561

Cumbernauld

△△ 01236 780000

Dalkeith

△△ 0131 663 2780

Dumbarton

△△ 01389 731682

Dumfries

△△△ 01387 264333

Dundee

△△ 01382 200454
△ 01382 220699

Dunfermline

△△ 01383 722337
△ 01383 731841

East Kilbride

△△ 01355 229317

Edinburgh

△△ 0131 2251234
△ 0131 557 9300

Elgin

△△ 01343 553939

Falkirk

△△ 01324 635 999

Fraserburgh

△△ 01346 517456

Galashiels

△△ 01896 750150

Glasgow

△△△ 0141 331 2807

Glasgow South

△△ 0141 649 8020

Glasgow West End

△△ 0141 353 2080

Greenock

△△ 01475 730717

Hamilton

△△ 01698 891400

Inverness

△△△ 01463 712239

Kilmarnock

△△ 01563 520318

Kirkcaldy

△△ 01592 205442

Lanark

△△ 01555 663058

Leeds

△ 0113 322 5069

Livingston

△△ 01506 416777

London

△△ 02033 761 236

Montrose

△△ 01674 676768

Musselburgh

△△ 0131 653 3456

Oban

△△ 01631 707 800

Paisley

△△ 0141 889 8334

Perth

△△ 01738 638188
△ 01738 631631

Peterhead

△△ 01779 470766

St Andrews

△△ 01334 477773
△ 01334 476469

Saltcoats

△△ 01294 464228

Stirling

△△ 01786 450438
△ 01786 474476