



56 Bovemoors Lane, Devon, EX2 5BP
Offers In Region Of £265,000 Freehold

MARTIN&CO

Bovemoors Lane

3 Bedrooms, 1 Bathroom

Offers In Region Of £265,000

- Three bedrooms
- First floor bathroom
- Sitting room
- Modern kitchen/breakfast
- Spacious ground floor utility/cloakroom
- Enclosed lawned rear garden with patio
- No chain



Score	Energy rating	Current	Potential
92+	A		
81-91	B		81 B
69-80	C	71 C	
55-68	D		
39-54	E		
21-38	F		
1-20	G		



DESCRIPTION A beautifully presented and modernised mid-terraced family home, ideally situated within easy walking distance of the Royal Devon & Exeter Hospital and close to a wide range of local amenities. The well-appointed accommodation includes an entrance hall, large lounge, stylish kitchen/breakfast room, spacious utility/cloakroom, three bedrooms, and a contemporary first-floor bathroom. Further benefits include gas central heating, uPVC double glazing, and an enclosed rear garden with lawn and patio. Offered to the market with no onward chain. Early viewing is highly recommended.

ENTRANCE HALL Accessed via a composite part glazed front door, front aspect frosted UPVC double glazed window, doors to the lounge, kitchen, toilet/utility room, under the stair storage cupboard, stairs to the first floor landing laminate. Radiator.

LOUNGE 13' 3" x 11' 2" (4.046m x 3.420m) Front aspect UPVC double glazed box Bay window, television points, wood laminate flooring and a radiator.

KITCHEN 11' 1" x 9' 9" (3.393m x 2.972m) Rear aspect UPVC double glazed window with a view over the rear garden, fitted range of eye and base level units, sink with a mixer tap and single drainer, roll edge work surfaces, electric cooker point, part tiled walls, laminate flooring and radiator.

CLOAKROOM/UTILITY ROOM 7' 10" x 6' 10" (2.402m x 2.083m) Rear aspect frosted UPVC double glazed window, low-level WC, wash hand basin, storage cupboard wall mounted boiler, laminate flooring, radiator.

FIRST FLOOR LANDING Doors to bedroom one, bedroom two, bedroom three, bathroom and access to the loft void above storage cupboard.

BEDROOM ONE 11' 2" x 10' 3" (3.417m x 3.135m) Rear aspect UPVC double glazed window with a view over the rear garden, wood laminate flooring, radiator

BEDROOM TWO 11' 5" x 10' 1" (3.483m x 3.082m) Front aspect UPVC double glazed window, television points, laminate flooring, radiator.

BEDROOM THREE 6' 8" x 7' 1" (2.047m x 2.175m) Front aspect UPVC double glazed window, laminate flooring, radiator.

BATHROOM Rear aspect UPVC double glazed frosted window, three piece white suite benefiting from a panel enclosed bath, low-level WC, wash hand basin, part tiled walls, laminate flooring, radiator.

REAR GARDEN A private enclosed garden by a range of panel fencing, paved seating area, further lawn with shrub boards and wooden gate providing rear access.

FRONT GARDEN Front garden mainly laid to lawn with shrub borders with pedestrian access leading to the front door.





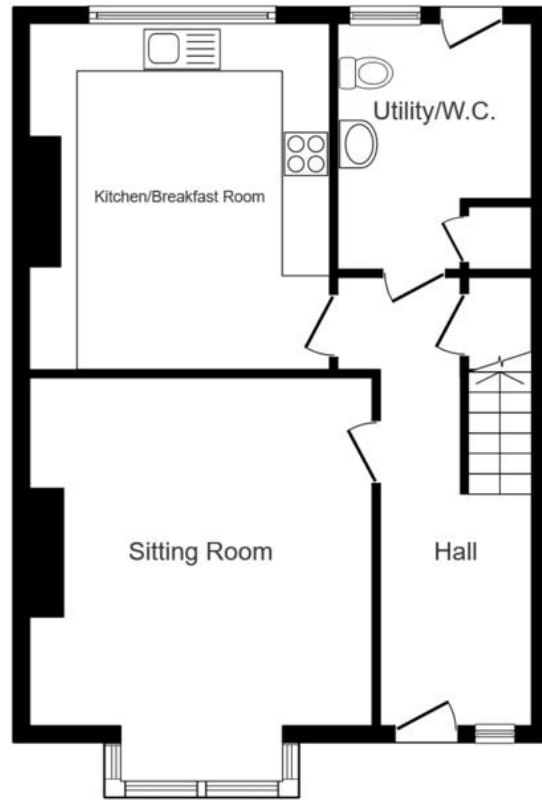

Ground Floor

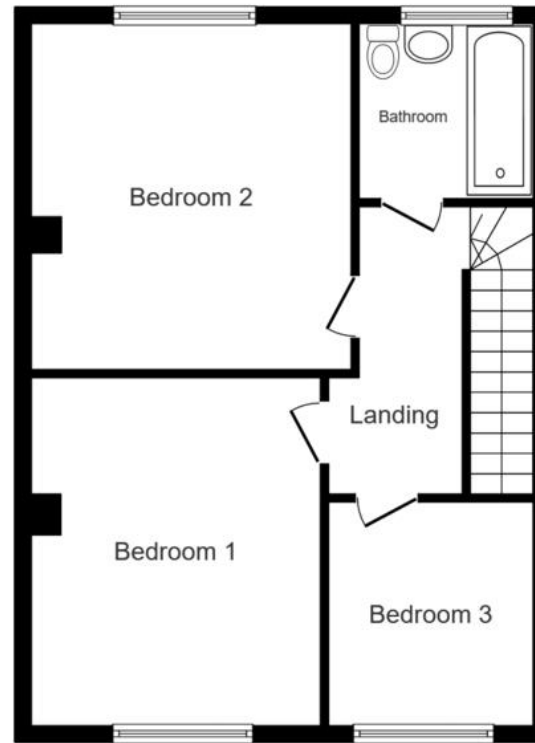

First Floor

This floor plan is for illustrative purposes only. It is not drawn to scale. Any measurements, floor areas (including any total floor area), openings and orientations are approximate. No details are guaranteed, they cannot be relied upon for any purpose and do not form any part of any agreement. No liability is taken for any error, omission or misstatement. A party must rely upon its own inspection(s). Powered by www.Propertybox.io

Martin & Co Exeter

82 South Street • Exeter • EX1 1EQ

T: • E:

<http://www.martinco.com>

MARTIN&CO

Accuracy: References to the Tenure of a Property are based on information supplied by the Seller. The Agent has not had sight of the title documents. A Buyer is advised to obtain verification from their Solicitor. Items shown in photographs including but not limited to carpets, fixtures and fittings are not included unless specifically mentioned within the sales particulars. They may however be available by separate negotiation. Buyers must check the availability of any property and make an appointment to view before embarking on any journey to see a property. No person in the employment of the agent has any authority to make any representation about the property, and accordingly any information given is entirely without responsibility on the part of the agents, sellers(s) or lessors(s). Any property particulars are not an offer or contract, nor form part of one. **Sonic / laser Tape:** Measurements taken using a sonic / laser tape measure may be subject to a small margin of error. **All Measurements:** All Measurements are Approximate. **Services Not tested:** The Agent has not tested any apparatus, equipment, fixtures and fittings or services and so cannot verify that they are in working order or fit for the purpose. A Buyer is advised to obtain verification from their Solicitor or Surveyor.