

TO LET

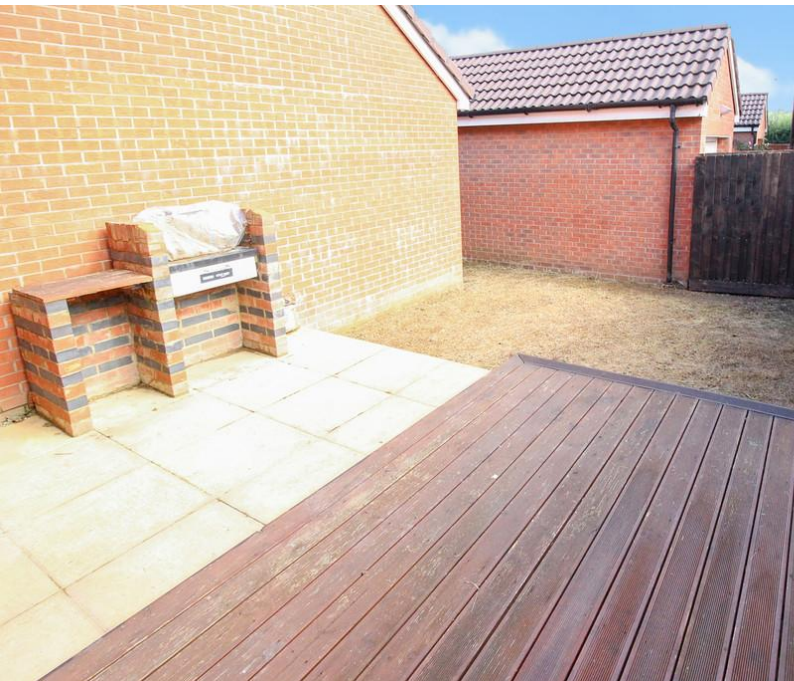

Linnet Lane, Melksham

2 Bedrooms, 2 Bathroom, End Terraced House

£1,050 pcm

MARTIN&CO



Linnet Lane, Melksham

End Terraced House,
2 bedroom, 2 bathroom

£1,050 pcm

Date available: 15th June
2026

Deposit: £1,210

Holding deposit: £240.00

Unfurnished

Council Tax band: B

- Recently Redecorated Two Bedroom End Terrace House
- Gas Central Heating
- Entrance Hall with Downstairs Cloakroom
- Living Room
- Fitted Kitchen
- Master Bedroom with En-Suite Shower Room
- Gardens, Driveway and Garage

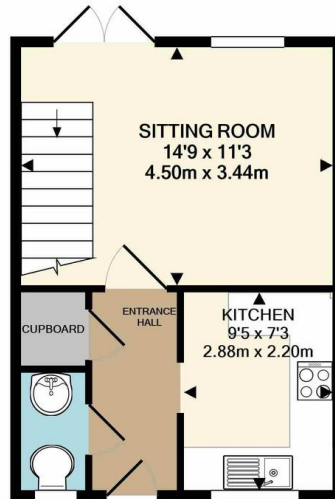
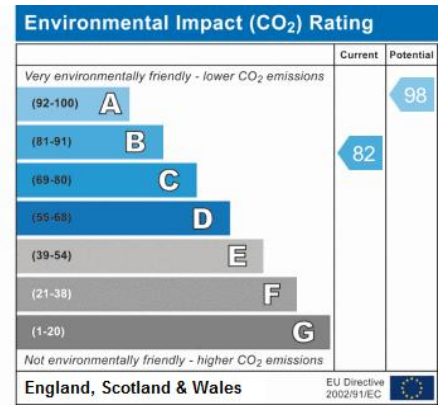
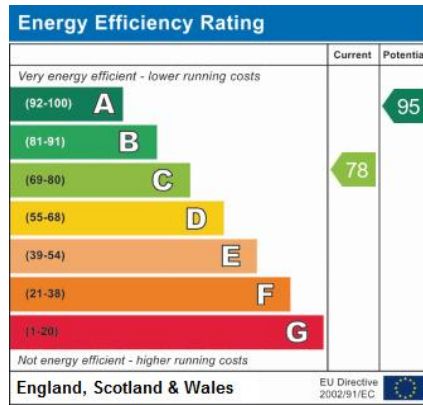

GROUND FLOOR

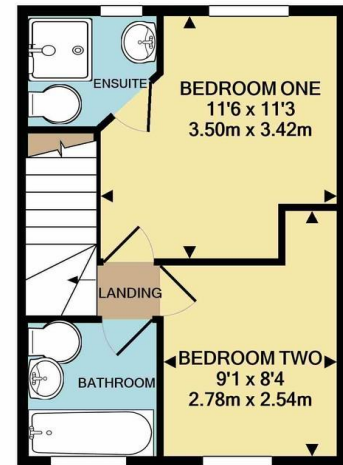

1ST FLOOR

Whilst every attempt has been made to ensure the accuracy of the floor plan contained here, measurements of doors, windows, rooms and any other items are approximate and no responsibility is taken for any error, omission, or mis-statement. This plan is for illustrative purposes only and should be used as such by any prospective purchaser. The services, systems and appliances shown have not been tested and no guarantee as to their operability or efficiency can be given
Made with Metropix ©2019

****Recently Redecorated Two Bedroom End Terrace House****Entrance Hall with Downstairs Cloakroom**Living Room**Fitted Kitchen**Master Bedroom with En-Suite Shower Room**Gardens, Driveway and Garage**Available Immediately for Long Term Let**

Martin & Co Westbury

7 Palomino Place • Westbury • Wiltshire • BA13 3SD
T: 01373 866686 • E: westbury@martinco.com

01373 866686
<http://www.martinco.com>



Accuracy: References to the Tenure of a Property are based on information supplied by the Seller. The Agent has not had sight of the title documents. A Buyer is advised to obtain verification from their Solicitor. Items shown in photographs including but not limited to carpets, fixtures and fittings are not included unless specifically mentioned within the sales particulars. They may however be available by separate negotiation. Buyers must check the availability of any property and make an appointment to view before embarking on any journey to see a property. No person in the employment of the agent has any authority to make any representation about the property, and accordingly any information given is entirely without responsibility on the part of the agents, sellers(s) or lessors(s). Any property particulars are not an offer or contract, nor form part of one. **Sonic / Laser Tape:** Measurements taken using a sonic / laser tape measure may be subject to a small margin of error. **All Measurements:** All Measurements are Approximate. **Services Not tested:** The Agent has not tested any apparatus, equipment, fixtures and fittings or services and so cannot verify that they are in working order or fit for the purpose. A Buyer is advised to obtain verification from their Solicitor or Surveyor.