

SOLD STC



Northfield Road, Gloucester

2 Bedrooms, 2 Bathroom, Terraced House

Asking Price Of £192,000

MARTIN&CO



- Mid-Terraced Home
- Two Double Bedrooms
- En-suite to Master
- Enclosed Rear Garden
- 2 spaces Parking
- Gas Central Heating
- Double Glazing

DESCRIPTION Price to sell - Soon to be vacant 2 bedroom, mid-terraced home situated on a no-through road, entrance hall, kitchen with integrated oven and gas hob, lounge with patio door to access southerly facing rear garden, two double bedrooms, master with en-suite, bathroom, gas central heating, double glazing and allocated parking for 2 vehicles. EPC - C, CTax B - No chain - soon to be vacant (please note the photographs were taking prior to the current tenant moving in)

ENTRANCE HALL stairs to first floor, door to the kitchen and door to the lounge

KITCHEN window to the front, range of eye and base units, sink and drainer, oven and hob

LOUNGE door to the rear garden

LANDING doors to the bedrooms and bathroom

BEDROOM 1 window to the front, door to the en-suite

ENSUITE modern suite with WC, wash basin and shower

BEDROOM 2 double glazed window to the rear

BATHROOM white suite comprising WC, wash basin, bath

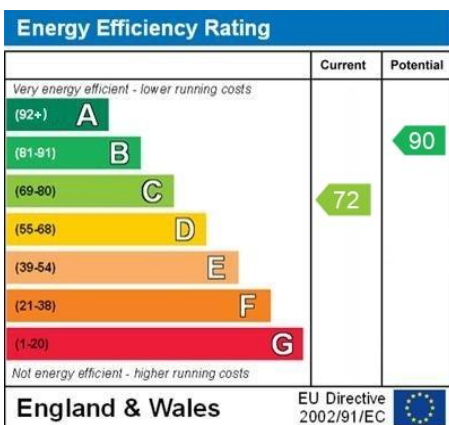



OUTSIDE to the front there is allocated parking, to the rear is a decent sized rear garden laid to lawn and shrubs

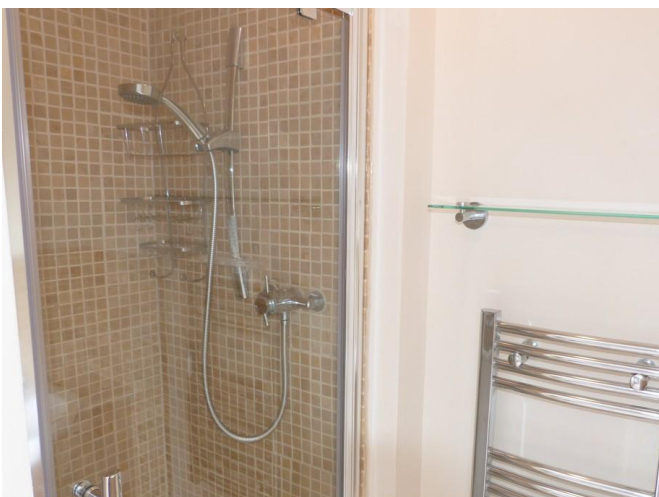

GROUND FLOOR
280 sq.ft. (26.0 sq.m.) approx.

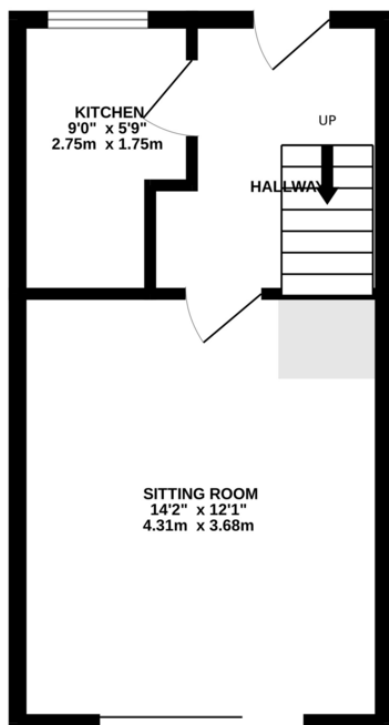

1ST FLOOR
280 sq.ft. (26.0 sq.m.) approx.

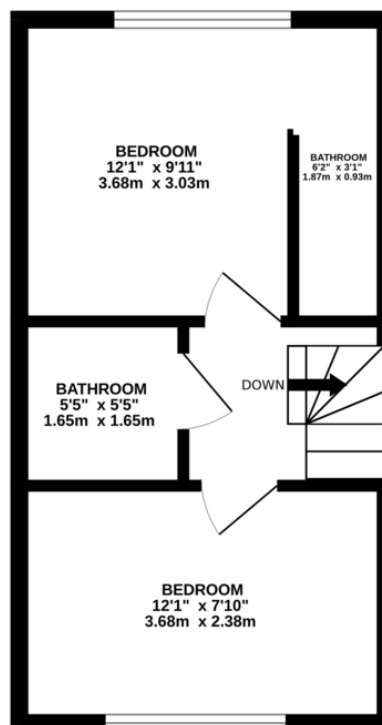

45 NORTHFIELD ROAD

TOTAL FLOOR AREA : 559 sq.ft. (51.9 sq.m.) approx.

Whilst every attempt has been made to ensure the accuracy of the floorplan contained here, measurements of doors, windows, rooms and any other items are approximate and no responsibility is taken for any error, omission or mis-statement. This plan is for illustrative purposes only and should be used as such by any prospective purchaser. The services, systems and appliances shown have not been tested and no guarantee as to their operability or efficiency can be given.
Made with Metropix ©2025

Martin & Co Gloucester

13-15 Worcester Street • Gloucester • GL1 3AJ
T: 01452 528333 • E: gloucester@martinco.com

01452 528333

<http://www.martinco.com>



Accuracy: References to the Tenure of a Property are based on information supplied by the Seller. The Agent has not had sight of the title documents. A Buyer is advised to obtain verification from their Solicitor. Items shown in photographs including but not limited to carpets, fixtures and fittings are not included unless specifically mentioned within the sales particulars. They may however be available by separate negotiation. Buyers must check the availability of any property and make an appointment to view before embarking on any journey to see a property. No person in the employment of the agent has any authority to make any representation about the property, and accordingly any information given is entirely without responsibility on the part of the agents, sellers(s) or lessors(s). Any property particulars are not an offer or contract, nor for m part of one. **Sonic / laser Tape:** Measurements taken using a sonic / laser tape measure may be subject to a small margin of error. **All Measurements:** All Measurements are Approximate. **Services Not tested:** The Agent has not tested any apparatus, equipment, fixtures and fittings or services and so cannot verify that they are in working order or fit for the purpose. A Buyer is advised to obtain verification from their Solicitor or Surveyor.