

FOR SALE



Longhorn Avenue, Gloucester

2 Bedrooms, 1 Bathroom, Top Floor Apartment With Views

Asking Price Of £140,000

MARTIN&CO



- Modern Top Floor Apartment
- Views to May Hill
- 2 Double Bedrooms
- Open Plan Living
- Gas Central Heating
- Double Glazing
- Allocated Parking
- No Chain
- EPC C
- CTax B

%epcGraph_c_1_331%

DESCRIPTION AVAILABLE NOW - Views to May Hill-top floor flat offering 2 double bedrooms, lounge/diner with door to Juliet balcony, modern bathroom & kitchen, gas central heating, UPVC Double Glazing, freshly decorated, allocated parking, EPC C, CTax B - No Chain

HALLWAY

A generous hallway with two store cupboards, doors to all rooms

LOUNGE/DINER

A generous lounge/diner with double glazed door open on to the Juliet balcony offering views as far as May Hill, archway to:-

KITCHEN

Window to the front, range of eye and base units, sink and drainer, built in oven and hob with extractor over, appliance space for fridge/freezer and washing machine, modern gas central heating boiler

BEDROOM 1

Double bedroom with window to the rear

BEDROOM 2

Double bedroom with window to the rear

BATHROOM Window to the front comprising WC Wash basin and bath with shower over



OUTSIDE allocate space next to the front door

CURRENT CHARGES Property Service Charge
£1,673.79

Ground Rent Is £280.00

Service Charge for Leachate (Drains) £40.26



GROUND FLOOR
660 sq.ft. (61.3 sq.m.) approx.

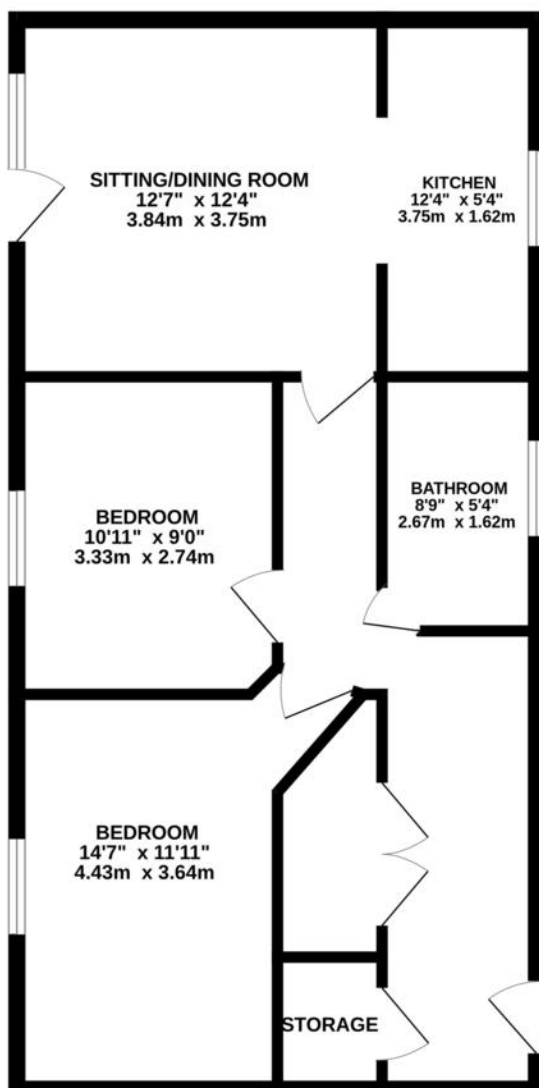

TOTAL FLOOR AREA : 660 sq.ft. (61.3 sq.m.) approx.

Whilst every attempt has been made to ensure the accuracy of the floorplan contained here, measurements of doors, windows, rooms and any other items are approximate and no responsibility is taken for any error, omission or mis-statement. This plan is for illustrative purposes only and should be used as such by any prospective purchaser. The services, systems and appliances shown have not been tested and no guarantee as to their operability or efficiency can be given.
Made with Metropix ©2025

Martin & Co Gloucester

13-15 Worcester Street • Gloucester • GL1 3AJ
T: 01452 528333 • E: gloucester@martinco.com

01452 528333

<http://www.martinco.com>



Accuracy: References to the Tenure of a Property are based on information supplied by the Seller. The Agent has not had sight of the title documents. A Buyer is advised to obtain verification from their Solicitor. Items shown in photographs including but not limited to carpets, fixtures and fittings are not included unless specifically mentioned within the sales particulars. They may however be available by separate negotiation. Buyers must check the availability of any property and make an appointment to view before embarking on any journey to see a property. No person in the employment of the agent has any authority to make any representation about the property, and accordingly any information given is entirely without responsibility on the part of the agents, sellers(s) or lessors(s). Any property particulars are not an offer or contract, nor for m part of one. **Sonic / laser Tape:** Measurements taken using a sonic / laser tape measure may be subject to a small margin of error. **All Measurements:** All Measurements are Approximate. **Services Not tested:** The Agent has not tested any apparatus, equipment, fixtures and fittings or services and so cannot verify that they are in working order or fit for the purpose. A Buyer is advised to obtain verification from their Solicitor or Surveyor.