

SOLD STC



Suffolk Drive, Gloucester

1 Bedroom, 1 Bathroom, Apartment, Large Balcony

Asking Price Of £129,950

MARTIN&CO



- Top Floor Apartment
- Lift Access
- One Bedroom
- Lounge/Diner
- Large Balcony
- Gas Central Heating
- Double Glazing
- EPC C
- CTax A

DESCRIPTION BALCONY & LIFT

A large top floor apartment with an impressive balcony offering views over the city. The flat offers a modern open plan living/dining area with door to the balcony, a modern fitted kitchen, large double bedroom, modern bathroom, double glazing, gas central heating, allocated parking space. Council Tax - A, EPC - C, CHAIN FREE

HALLWAY

Hallway with doors to all rooms, storage cupboard, radiator

LIVING AREA

A generous lounge and dining area, door to the balcony, radiator, arch to the kitchen

KITCHEN

Window to the front, modern fitted eye and base units, sink and drainer, oven and hob with extractor over

BEDROOM Good sized double bedroom with window to the front and radiator

BATHROOM modern suite comprising WC, wash basin and bath with shower over

OUTSIDE

Large balcony to the front, allocated parking space at the rear

Energy Efficiency Rating		
	Current	Potential
Very energy efficient - lower running costs		
(92+) A		
(81-91) B		
(69-80) C	78	78
(55-68) D		
(39-54) E		
(21-38) F		
(1-20) G		
Not energy efficient - higher running costs		
England & Wales	EU Directive 2002/91/EC	

WWW.EPC4U.COM

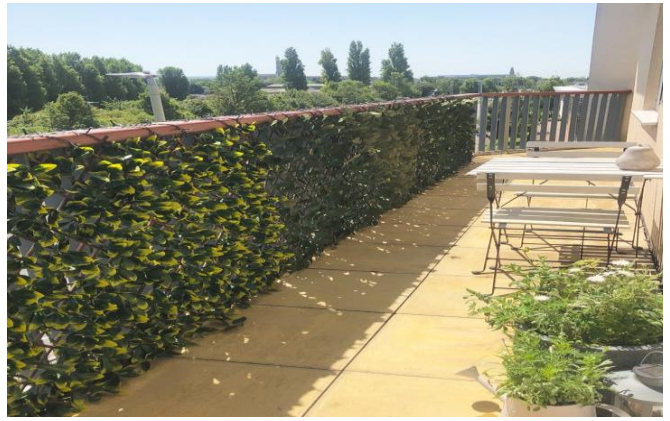

CHARGES

Lease approx. 107yrs remain

Service Charge £1419.91

Ground rent £225

We advise these charges are check by your solicitors at the time of purchase



GROUND FLOOR
575 sq.ft. (53.4 sq.m.) approx.

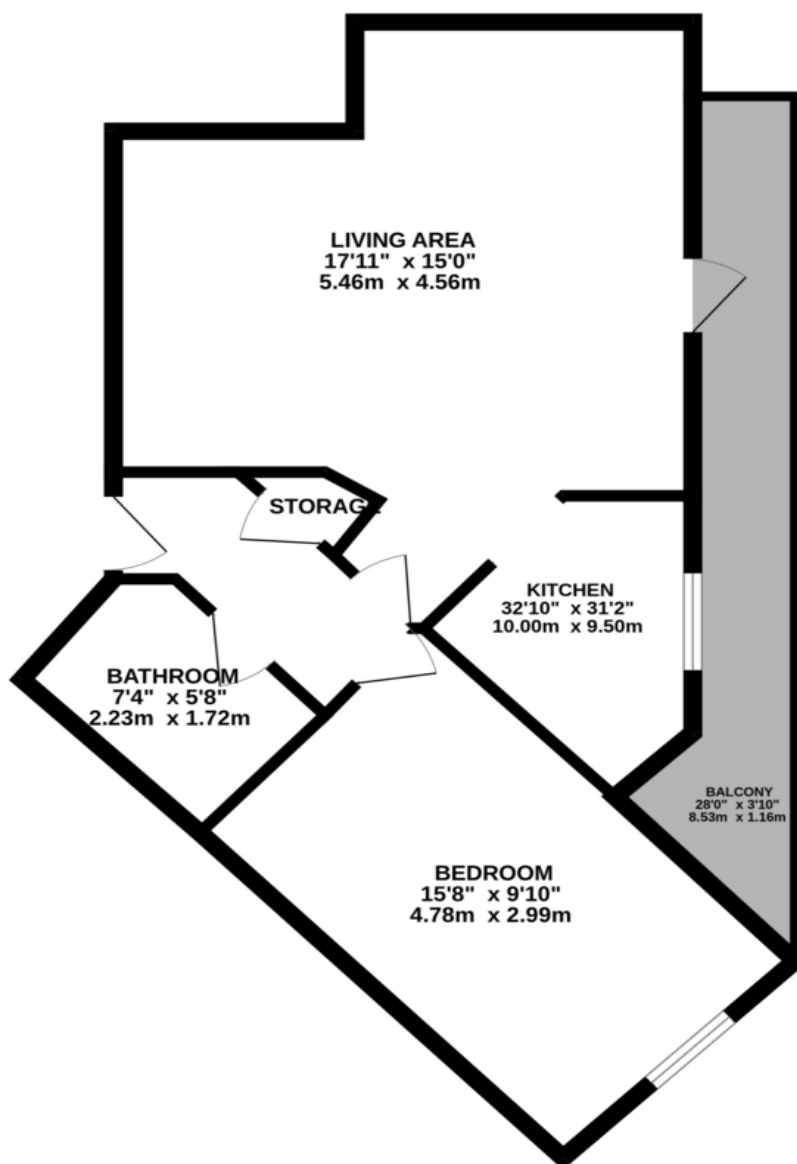

TOTAL FLOOR AREA : 575 sq.ft. (53.4 sq.m.) approx.

Whilst every attempt has been made to ensure the accuracy of the floorplan contained here, measurements of doors, windows, rooms and any other items are approximate and no responsibility is taken for any error, omission or mis-statement. This plan is for illustrative purposes only and should be used as such by any prospective purchaser. The services, systems and appliances shown have not been tested and no guarantee as to their operability or efficiency can be given.
Made with Metropix ©2024

Martin & Co Gloucester

13-15 Worcester Street • Gloucester • GL1 3AJ
T: 01452 528333 • E: gloucester@martinco.com

01452 528333

<http://www.martinco.com>



Accuracy: References to the Tenure of a Property are based on information supplied by the Seller. The Agent has not had sight of the title documents. A Buyer is advised to obtain verification from their Solicitor. Items shown in photographs including but not limited to carpets, fixtures and fittings are not included unless specifically mentioned within the sales particulars. They may however be available by separate negotiation. Buyers must check the availability of any property and make an appointment to view before embarking on any journey to see a property. No person in the employment of the agent has any authority to make any representation about the property, and accordingly any information given is entirely without responsibility on the part of the agents, sellers(s) or lessors(s). Any property particulars are not an offer or contract, nor for part of one. **Sonic / laser Tape:** Measurements taken using a sonic / laser tape measure may be subject to a small margin of error. **All Measurements:** All Measurements are Approximate. **Services Not tested:** The Agent has not tested any apparatus, equipment, fixtures and fittings or services and so cannot verify that they are in working order or fit for the purpose. A Buyer is advised to obtain verification from their Solicitor or Surveyor.