

LET



Canons Close, Bath
£1,300 pcm

MARTIN&CO

Canons Close, Bath

Date available: 29th July 2025

Deposit: £1,500

Furnished

Council Tax band:

- Student house
- Two bedrooms - one double, one single
- Living room
- Kitchen / diner
- Study
- Garden
- Available July 2024

Energy Efficiency Rating

	Current	Potential
Very energy efficient - lower running costs		
(92+) A		
(81-91) B		89
(69-80) C	72	
(55-68) D		

Furnished two bedroom student property available 29th July, with living room, kitchen / diner, and separate study.

Approximate Gross Internal Area
64.72 sq m / 696.64 sq ft

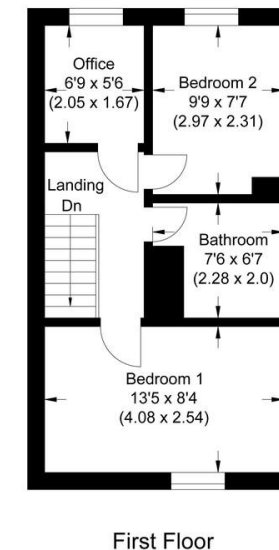
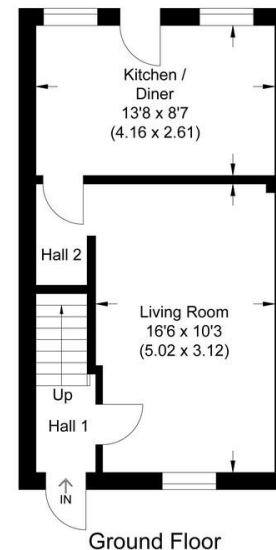

Illustration for identification purposes only, measurements are approximate, not to scale.

Martin & Co Bath

1 Cleveland Terrace • Bath • BA1 5DF

T: 01225 429999 • E: bath@martinco.com

01225 429999

<http://www.martinco.com>

MARTIN&CO

Accuracy: References to the Tenure of a Property are based on information supplied by the Seller. The Agent has not had sight of the title documents. A Buyer is advised to obtain verification from their Solicitor. Items shown in photographs including but not limited to carpets, fixtures and fittings are not included unless specifically mentioned within the sales particulars. They may however be available by separate negotiation. Buyers must check the availability of any property and make an appointment to view before embarking on any journey to see a property. No person in the employment of the agent has any authority to make any representation about the property, and accordingly any information given is entirely without responsibility on the part of the agents, sellers(s) or lessors(s). Any property particulars are not an offer or contract, nor form part of one. **Sonic / Laser Tape:** Measurements taken using a sonic / laser tape measure may be subject to a small margin of error. **All Measurements:** All Measurements are Approximate. **Services Not tested:** The Agent has not tested any apparatus, equipment, fixtures and fittings or services and so cannot verify that they are in working order or fit for the purpose. A Buyer is advised to obtain verification from their Solicitor or Surveyor.