

SOLD STC



Mountcastle Road, Leicester

3 Bedrooms, 1 Bathroom, Mid Terraced House

Asking Price Of £195,000





- Leicester City Council
- EPC - E
- Located In The West End
- Open- plan living/dining/kitchen area
- Ground floor bathroom with W/C
- Council Tax Band - A
- Freehold

PROPERTY DESCRIPTION Upon entering, you are welcomed into a spacious livingroom. The open- plan, dining, and kitchen area, offering a fantastic social layout with plenty of natural light. The open plan creates a warm and inviting feel, ideal for families and those who love entertaining.

To the rear of the property, you'll find a modern bathroom and W/C conveniently located on the ground floor.

Upstairs, the property boasts three good- sized bedrooms, all well- presented and suitable for children, guests, or use as a home office.

Outside, the home features a private, low- maintenance decked garden, perfect for hosting gatherings, enjoying summer evenings, or simply relaxing.

This property is ideal for first- time buyers, investors, or growing families looking for a home they can move straight into. Viewings are highly recommended to fully appreciate the space and potential on offer.

Score	Energy rating	Current	Potential
92+	A		
81-91	B		
69-80	C		72 C
55-68	D		
39-54	E	48 E	
21-38	F		
1-20	G		

LIVING ROOM 10' 8" x 11' 4" (3.25m x 3.45m)

DINNING ROOM 10' 8" x 14' 10" (3.25m x 4.52m)

KITCHEN 6' 1" x 12' 9" (1.85m x 3.89m)

BATHROOM 6' 1" x 5' 9" (1.85m x 1.75m)

WC 6' 4" x 2' 4" (1.93m x 0.71m)

BEDROOM ONE 12' 3" x 11' 4" (3.73m x 3.45m)



BEDROOM TWO 9' 5" x 11' 11" (2.87m x 3.63m)



BEDROOM THREE 6' 2" x 12' 10" (1.88m x 3.91m)



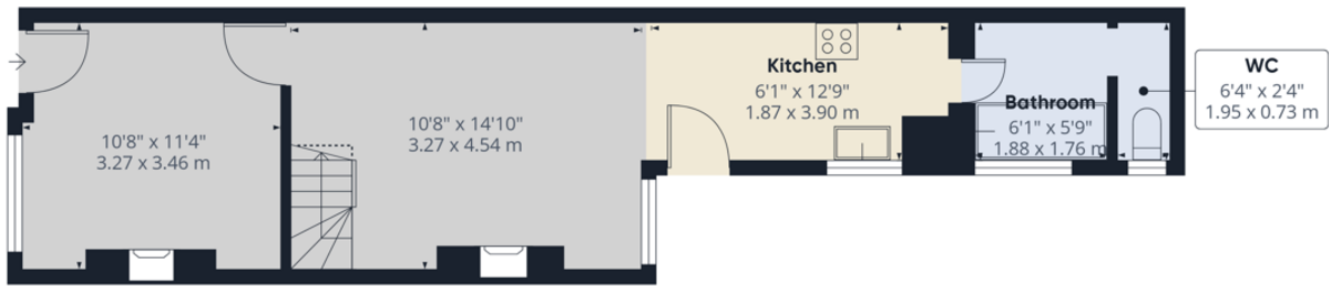

Martin & Co Leicester

Unit 13 Stoughton Park, Gartree Road • Leicester • LE2
2FB

T: 0116 204 4920 • E: leicester@martinco.com

0116 204 4920
<http://www.martinco.com>



Accuracy: References to the Tenure of a Property are based on information supplied by the Seller. The Agent has not had sight of the title documents. A Buyer is advised to obtain verification from their Solicitor. Items shown in photographs including but not limited to carpets, fixtures and fittings are not included unless specifically mentioned within the sales particulars. They may however be available by separate negotiation. Buyers must check the availability of any property and make an appointment to view before embarking on any journey to see a property. No person in the employment of the agent has any authority to make any representation about the property, and accordingly any information given is entirely without responsibility on the part of the agents, sellers(s) or lessors(s). Any property particulars are not an offer or contract, nor for part of one. **Sonic / laser Tape:** Measurements taken using a sonic / laser tape measure may be subject to a small margin of error. **All Measurements:** All Measurements are Approximate. **Services Not tested:** The Agent has not tested any apparatus, equipment, fixtures and fittings or services and so cannot verify that they are in working order or fit for the purpose. A Buyer is advised to obtain verification from their Solicitor or Surveyor.