

TO LET



Lowther Road, Dover

2 Bedrooms, 1 Bathroom, End Terraced House

£995 pcm



Lowther Road, Dover

End Terraced House,
2 bedroom, 1 bathroom

£995 pcm

Date available: Available Now

Deposit: £1,148.07

Unfurnished

Council Tax band: B

- Good Size Lounge
- Kitchen
- Garden with Side Entrance
- Ample storage in Hallway
- Two Bedrooms
- Study
- Council Tax Band - B

PROPERTY DETAILS MARTIN&CO are delighted to offer this delightful two bedroom home with a extra room perfect for a study or walk in wardrobe to the market.

The property has been kept in a lovely condition and comprises of a lounge, modern kitchen with a built-in oven and hob, as well as space for a washing machine and a tall fridge-freezer, compact bathroom and two bedrooms upstairs.

One double bedroom, one single bedroom, and a box room ideally suited as a home office or nursery.

The property also benefits from a landscaped garden to the rear.

APPLICANT PROFILE This landlord will only consider

%epcGraph_c_1_331%



applicants with an income of at least £29,850 per annum (jointly). Forms of considered income are:

- * Basic salary for contracted hours only
- * Tax Credits
- * Pensions or a mixture of these.

Forms of income which will be considered on a case-by-case basis are:

- * Commission
- * Self-employment
- * Dividends
- * Liquid funds
- * Benefits awarded by means of a benefit award letter

The landlord will accept up to one child. Applicants who will be sharing, those with pets or those who smoke will not be considered for this property.

A refundable holding deposit of £230.00 is payable upon acceptance of your application. All income must be evidenced by documents. Applicants cannot be considered without the above income requirement also being met. Consideration is given to those who are legally disabled or in receipt of Personal Independence Payment (PIP), formerly Disability Living Allowance (DLA). All applicants are expected to have a clean credit score and a positive landlord reference if they are currently in rented accommodation.

Applicants will be asked to produce government issued

photographic ID as well as a recent proof of address such as a utility bill, a council tax bill or a letter from your employer, but not a bank statement or a mobile phone bill. We would ask for your cooperation in order that there will be no delay in agreeing the let (subject to references and subject to contract).

Please contact Martin & Co for full details.



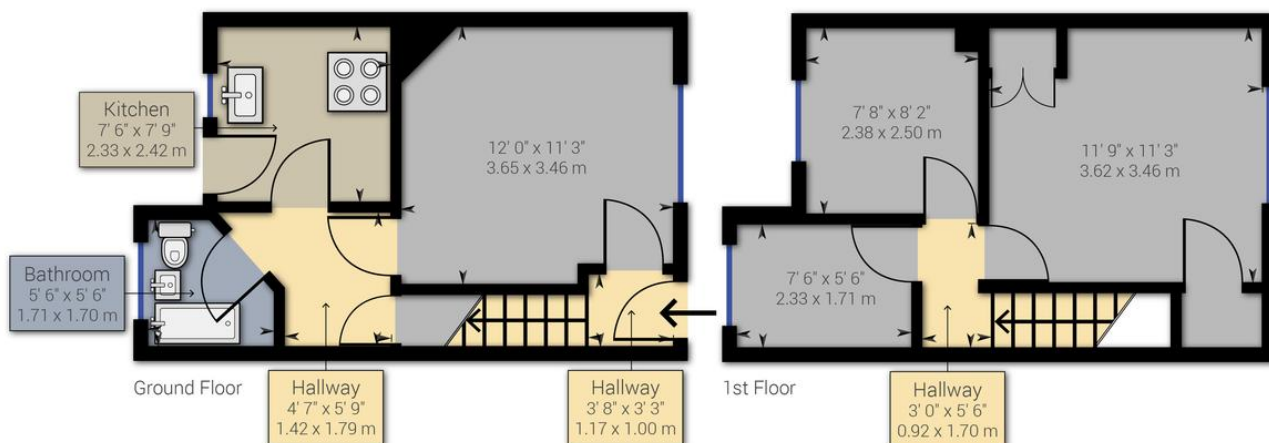

Approximate net internal area: 553.90 ft² / 51.46 m²

While every attempt has been made to ensure accuracy, all measurements are approximate, not to scale. This floor plan is for illustrative purpose only and should be used as such by any prospective tenant or purchaser.

Powered by Giraffe360

Martin & Co Dover

130 Sandgate Road • • Folkestone • CT20 2BW
T: 01304 213312 • E: dover@martinco.com

01304 213312
<http://www.martinco.com>



Accuracy: References to the Tenure of a Property are based on information supplied by the Seller. The Agent has not had sight of the title documents. A Buyer is advised to obtain verification from their Solicitor. Items shown in photographs including but not limited to carpets, fixtures and fittings are not included unless specifically mentioned within the sales particulars. They may however be available by separate negotiation. Buyers must check the availability of any property and make an appointment to view before embarking on any journey to see a property. No person in the employment of the agent has any authority to make any representation about the property, and accordingly any information given is entirely without responsibility on the part of the agents, sellers(s) or lessors(s). Any property particulars are not an offer or contract, nor for part of one. **Sonic / laser Tape:** Measurements taken using a sonic / laser tape measure may be subject to a small margin of error. **All Measurements:** All Measurements are Approximate. **Services Not tested:** The Agent has not tested any apparatus, equipment, fixtures and fittings or services and so cannot verify that they are in working order or fit for the purpose. A Buyer is advised to obtain verification from their Solicitor or Surveyor.