

FOR SALE



Two Bedroom, Two Bathroom Apartment, Berwick Place, Welwyn Garden City
ASKING PRICE OF £250,000

MARTIN & CO



Berwick Place, Welwyn Garden City

2 Bedrooms, 2 Bathrooms

ASKING PRICE OF £250.000

- Two Bedroom, Two Bathroom Apartment
- Top Floor
- Ensuite and built-in wardrobe to Master
- Allocated Parking
- Quiet location approx. 2 miles from the Town Centre and Train Station

SUMMARY

This well presented modern **TWO BEDROOM 2ND FLOOR** Apartment is located in this popular development within walking distance of the Town Centre and Train Station. The property features an open-plan reception and modern fitted kitchen, two double bedrooms, bathroom, ensuite to master, and allocated parking. Berwick Place is well placed within easy reach of local shops, amenities and excellent road and rail links. Viewing is highly recommended!

ENTRANCE HALL

Laminate floor, radiator, entry-phone system, storage cupboard housing utility meters, loft hatch, smoke detector, ceiling light.



OPEN-PLAN LOUNGE/DINER/KITCHEN

Vinyl floor, a range of wall and base units with fan, ceiling light.

laminated work surfaces, stainless steel sink

with mixer tap, part-tiled walls, integrated oven **BEDROOM TWO**

and hob, fridge, freezer and washing machine, Carpet, radiator, double-glazed window with ceiling lights. The lounge area features carpet, fitted blind, storage cupboard housing two radiators, double-glazed window with Worcester boiler.

fitted blind, coving, ceiling lights x 2.

BATHROOM

Vinyl floor, radiator, three piece bathroom suite comprising panel enclosed bath with shower attachment, pedestal sink with stainless steel taps, low-level flush WC, part-tiled walls, extractor fan, ceiling light.

BEDROOM ONE

Carpet, radiator, double-glazed window with fitted blind, built-in double wardrobe, coving, ceiling lights. Door leading to;

ENSUITE TO MASTER

Vinyl floor, radiator, low-level flush WC, **EXTERNAL SPACE**

pedestal sink with mixer tap, fully tiled double **Allocated parking space. Communal gardens.**





Score	Energy rating	Current	Potential
92+	A		
81-91	B	81 B	81 B
69-80	C		
55-68	D		
39-54	E		
21-38	F		
1-20	G		



Approximate Gross Internal Area = 59.1 sq m / 636 sq ft

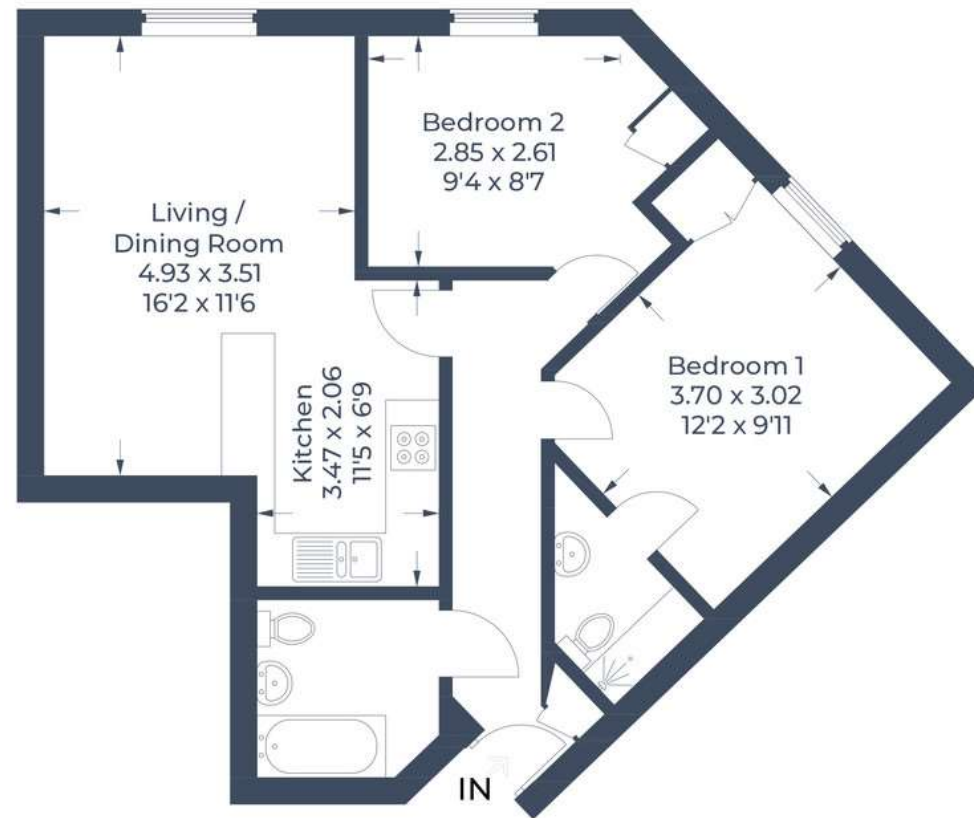

Second Floor

Illustration for identification purposes only,
measurements are approximate, not to scale.

© 2017 Property Marketing Produced for Martin & Co

Martin & Co Welwyn

16 Howardsgate • Welwyn Garden City • AL8 6BQ
T: 01707 334576 • E: welwyn@martinco.com

01707 334576

<http://welwyn.martinco.com>



Accuracy: References to the Tenure of a Property are based on information supplied by the Seller. The Agent has not had sight of the title documents. A Buyer is advised to obtain verification from their Solicitor. Items shown in photographs including but not limited to carpets, fixtures and fittings are not included unless specifically mentioned within the sales particulars. They may however be available by separate negotiation. Buyers must check the availability of any property and make an appointment to view before embarking on any journey to see a property. No person in the employment of the agent has any authority to make any representation about the property, and accordingly any information given is entirely without responsibility on the part of the agents, sellers(s) or lessors(s). Any property particulars are not an offer or contract, nor form part of one. **Sonic / Laser Tape:** Measurements taken using a sonic / laser tape measure may be subject to a small margin of error. **All Measurements:** All Measurements are Approximate. **Services Not tested:** The Agent has not tested any apparatus, equipment, fixtures and fittings or services and so cannot verify that they are in working order or fit for the purpose. A Buyer is advised to obtain verification from their Solicitor or Surveyor.

