



**Danbury Vale, Chelmsford, CM3 4LA**  
Asking Price Of £635,000 Freehold

  
**MARTIN&CO**

# Danbury Vale, Danbury

4 Bedrooms, 2 Bathroom

Asking Price Of £635,000

- VIRTUAL VIEWING AVAILABLE
- OPEN PLAN LIVING ROOM
- DINING ROOM
- FULLY FITTED KITCHEN BREAKFAST ROOM
- BI FOLD DOORS ACROSS THE REAR
- ENSUITE TO MAIN BEDROOM
- ONE AND A HALF WIDTH GARAGE

INTRODUCTION If you are looking for a family home, a short distance from the village centre, within the Danbury Park School catchment area, then look no further.

This extended four fabulous refitted spacious kitchen breakfast room also with bifold doors opening onto the rear garden. Upstairs are four good sized bedrooms, and ensuite ad family bathroom wc. Outside the wide frontage provides



Score	Energy rating	Current	Potential
92+	A		
81-91	B		81   B
69-80	C	73   C	
55-68	D		
39-54	E		
21-38	F		
1-20	G		

ample of road parking for 3 to 4 cars leading to the one and a half width garage. To the rear the property enjoys a south westerly aspect rear garden. Early Viewing is highly recommended.

Danbury Villages offer a whole host of facilities including local shops including Tesco express, Co-op and Boots, a medical centre, dentist, veterinary surgery, coffee shops, sports centre, choice of schools and churches and public houses to name just a few. Danbury is surrounded by managed woodland and is a haven for wildlife. The Park and Ride to Chelmsford City centre is just a short drive away, as well as access to the A12 and A130.

Note the Vendor has found an onward purchase with no chain.  
EPC rating C.

Click on the virtual Viewing below.

ENTRANCE HALL 6' 1" x 5' 3" (1.85m x 1.6m)

LIVING ROOM 12' 11" x 18' 8" (3.94m x 5.69m)

DINING ROOM 10' 6" x 10' 1" (3.2m x 3.07m)

KITCHEN/BREAKFAST ROOM 22' 2" x 12' 2" (6.76m x 3.71m) max

CLOAKROOM WC

MAIN BEDROOM 16' 6" x 12' 4" (5.13m x 3.76m)

DRESSING ROOM/STUDY 6' 6" x 6' 0" (1.98m x 1.83m)

ENSUITE 5' 10" x 6' 6" (1.78m x 1.98m)

BEDROOM TWO 10' 3" x 9' 6" (3.12m x 2.9m)

BEDROOM THREE 10' 3" x 9' 6" (3.12m x 2.9m) + door recess

BEDROOM FOUR 9' 5" x 8' 9" (2.87m x 2.67m)

FAMILY BATHROOM WC 7' 5" x 5' 7" (2.26m x 1.7m) .

LANDING 9' 4" x 9' 3" (2.84m x 2.82m)

GARAGE 12' 3" x 19' 3" (3.73m x 5.87m)

FRONTAGE AND PARKING

REAR GARDEN









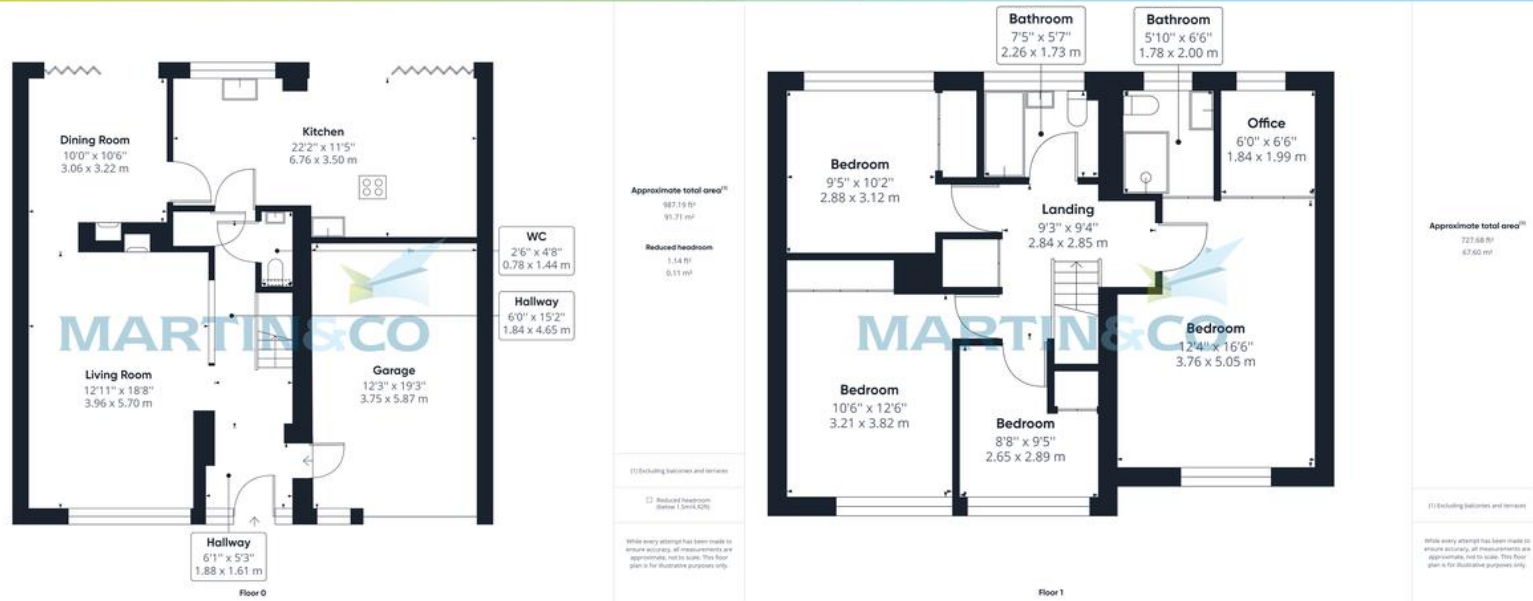

## Martin & Co Danbury

15 Duke Street • Chelmsford • CM1 1HL  
T: 01245 225525 • E: danbury@martinco.com

**01245 225525**  
<http://www.martinco.com>

**Accuracy:** References to the Tenure of a Property are based on information supplied by the Seller. The Agent has not had sight of the title documents. A Buyer is advised to obtain verification from their Solicitor. Items shown in photographs including but not limited to carpets, fixtures and fittings are not included unless specifically mentioned within the sales particulars. They may however be available by separate negotiation. Buyers must check the availability of any property and make an appointment to view before embarking on any journey to see a property. No person in the employment of the agent has any authority to make any representation about the property, and accordingly any information given is entirely without responsibility on the part of the agents, sellers(s) or lessors(s). Any property particulars are not an offer or contract, nor form part of one. **Sonic / laser Tape:** Measurements taken using a sonic / laser tape measure may be subject to a small margin of error. **All Measurements:** All Measurements are Approximate. **Services Not tested:** The Agent has not tested any apparatus, equipment, fixtures and fittings or services and so cannot verify that they are in working order or fit for the purpose. A Buyer is advised to obtain verification from their Solicitor or Surveyor.