







Built by Kebble Homes in 1988, this spacious four bedroom detached family home is situated on Herne Farm in a quiet cul de sac with a large south west facing garden. The house offers easy access to The Petersfield School, Churcher's College and the local junior schools. The town centre and high street are easily accessible.

The house offers a good sized sitting room with fitted gas fire, separate dining room with doors to the rear garden.

Refitted kitchen which is of excellent size and a separate refitted utility room.

On the first floor are four good sized bedrooms, the master having an ensuite shower room and there is a further refitted family bathroom.

Externally, the rear garden is south west facing and is a real feature being private and very well landscaped.

The property has a single garage alongside and a large, private driveway.

There is no onward chain with the house sale.

Gas central heating - Double glazed window upgraded in 2000.

Council Tax Band E - £2361 per annum

No onward Chain!

Viewing through the Vendors sole agent, Jacobs & Hunt.





WE ARE OPEN 7 DAYS A WEEK FOR YOUR VIEWING  
CONVENIENCE!



## Head Down, Petersfield

Approximate Gross Internal Area = 135.4 sq m / 1457 sq ft  
(Including Garage)

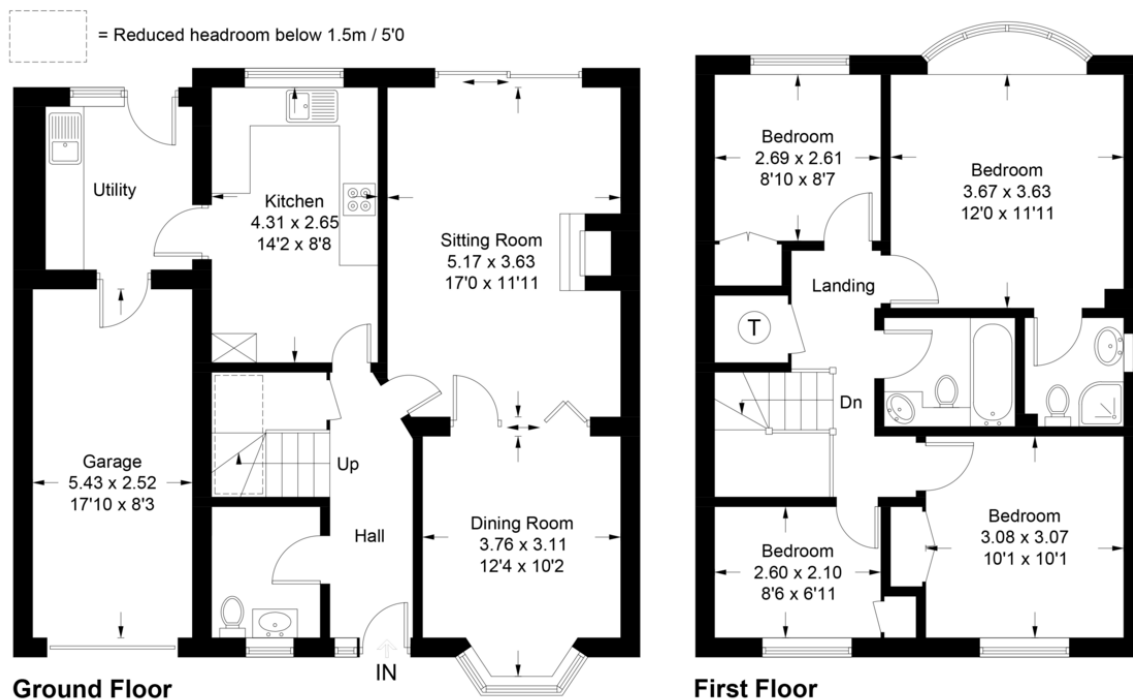

Illustration for identification purposes only,  
measurements are approximate, not to scale. (ID955277)



Score	Energy rating	Current	Potential
92+	A		
81-91	B		81   B
69-80	C		
55-68	D	60   D	
39-54	E		
21-38	F		

26 Lavant Street, Petersfield,  
Hampshire, GU32 3EF

www.jacobshunt.co.uk  
01730 262744  
properties@jacobshunt.co.uk

Agents Note: Whilst every care has been taken to prepare these particulars, they are for guidance purposes only. All measurements are approximate and for general guidance purposes only and whilst every care has been taken to ensure their accuracy, they should not be relied upon and potential buyers/tenants are advised to recheck the measurements



Zoopa rightmove OnTheMarket